

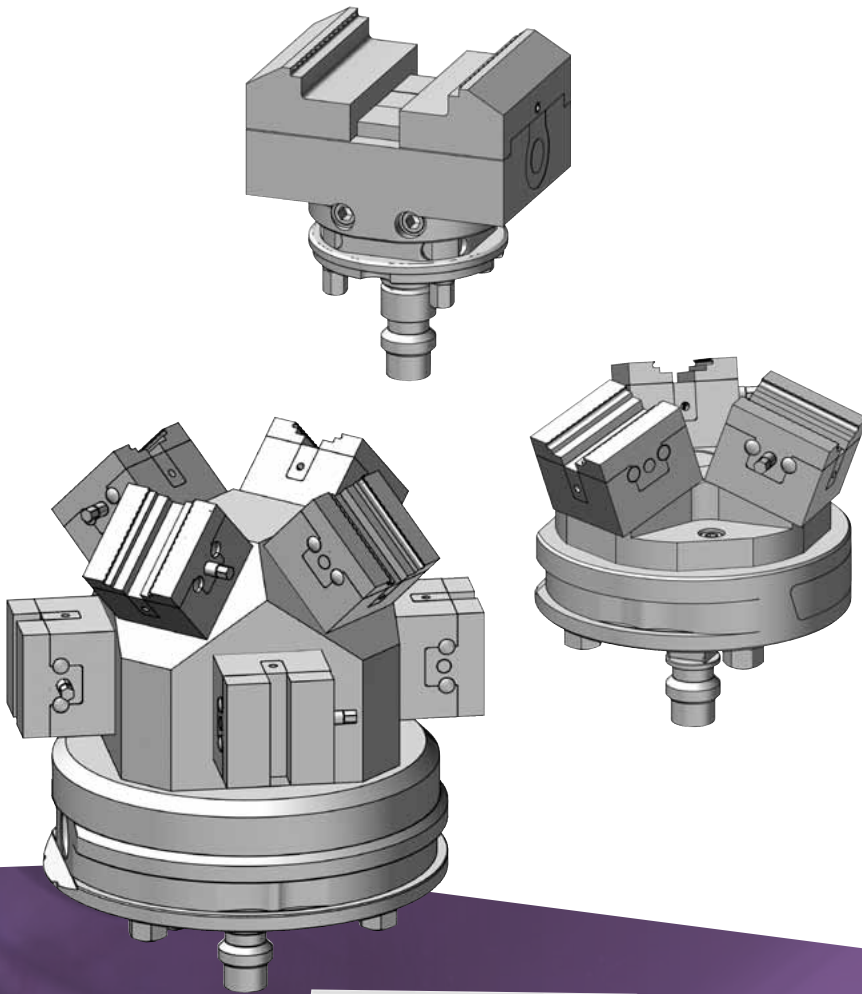

Maschinenspezifische Spannlösungen
Machine specific workholding solutions



TRIAG
INTERNATIONAL



RXP500DS
RXP500DSC
RXP501DS
RXP501DSC





triCENTRO

5-Achs Mehrfachspannpyramide mit Erowa Schnittstelle
 5-axis multiple workholding pyramid with Erowa interface

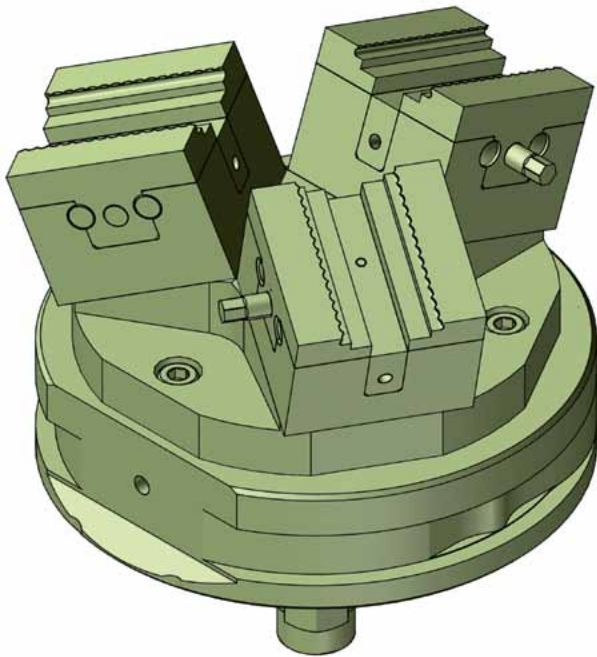

7 Backenvarianten
 Jaw variants

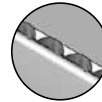

2,2 mm Direkt-Prägebacken
 2,2 mm Direct stamping jaws



«Sputnik» 5-Achs Mehrfachspannpyramide
 «Sputnik» 5-axis multiple workholding pyramid

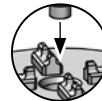

EROWA Schnittstelle
 EROWA interface



Beste Zugänglichkeit
 Best accessibility

Bestellschlüssel Order code	Bezeichnung Description	~ Kg	Spannstellen Clamping areas	Winkel Angle	Spannbereich Clamping area
RD500-SET1	Röders Set 1	3,65	3	20°	12 - 22

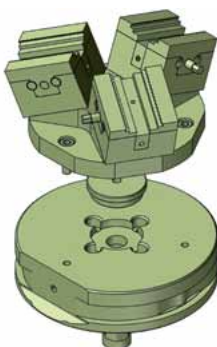

Drehmoment Torque		Spannkraft Workholding force		
Nm	(lb-ft)	~daN	~(lb)	~t
4	3	= 457	1'007	0,46
5	3,7	= 571	1'259	0,57
6	4,4	= 686	1'512	0,69
7	5,2	= 800	1'764	0,8

Backen gemäss Zusammenstellzeichnung falls nicht anders vereinbart.

Jaws according to assembly drawing if not agreed otherwise.

röders
TEC



RXP 500 DS / DSC



RXP 501 DS / DSC

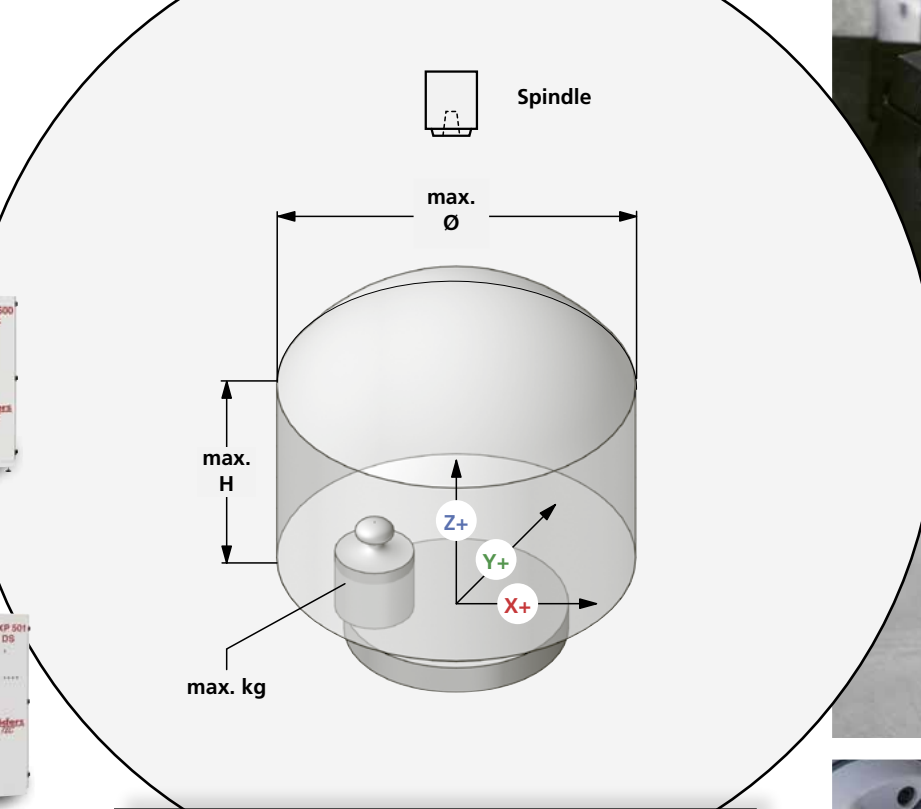

	X	Y	Z	max.		
				Ø	H	kg
RXP500DS	450 (X-316 X+134)	658 (Y-204 Y+454)	240	250	220	60
RXP500DSC	450 (X-316 X+134)	658 (Y-204 Y+454)	240	220	200	30
RXP501DS	500 (X-366 X+134)	700 (Y-230 Y+470)	300	250	200	60
RXP501DSC	500 (X-366 X+134)	700 (Y-230 Y+470)	300	220	200	30

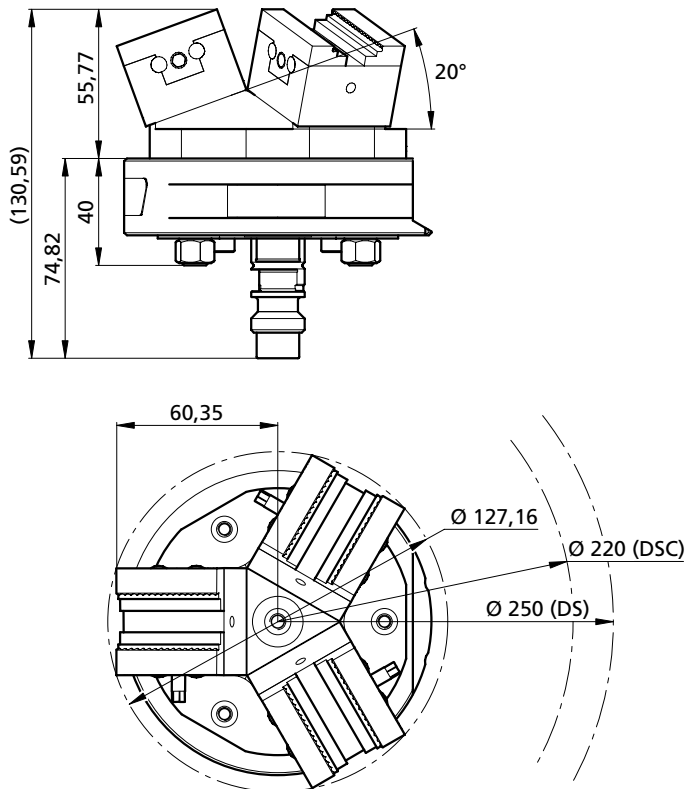

MICRO

Backenvarianten
Jaw variants

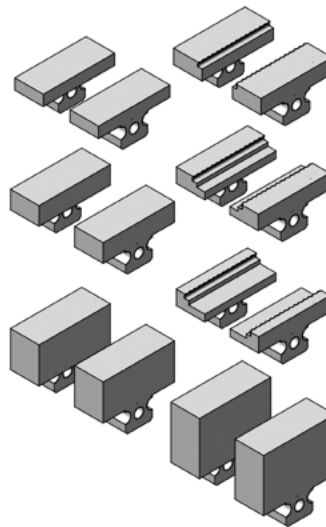

Mehr auf Seite 11
More on page 11





triCENTRO

5-Achs Mehrfachspannpyramide mit Erowa Schnittstelle
 5-axis multiple workholding pyramid with Erowa interface

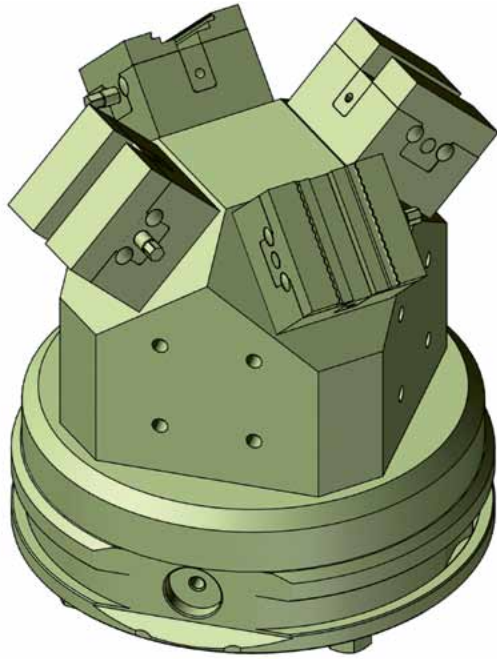

7 Backenvarianten
 Jaw variants

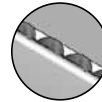

2,2 mm Direkt-Prägebacken
 2,2 mm Direct stamping jaws



«Sputnik» 5-Achs Mehrfachspannpyramide
 «Sputnik» 5-axis multiple workholding pyramid

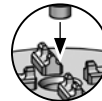

EROWA Schnittstelle
 EROWA interface



Beste Zugänglichkeit
 Best accessibility

Bestellschlüssel Order code	Bezeichnung Description	~ Kg	Spannstellen Clamping areas	Winkel Angle	Spannbereich Clamping area
RD500-SET2	Röders Set 2	4,13	4	45°	12 - 22

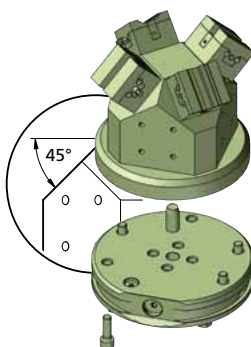

Drehmoment Torque		Spannkraft Workholding force		
Nm	(lb-ft)	= ~daN	~(lb)	~t
4	3	= 457	1'007	0,46
5	3,7	= 571	1'259	0,57
6	4,4	= 686	1'512	0,69
7	5,2	= 800	1'764	0,8

Backen gemäss Zusammenstellzeichnung falls nicht anders vereinbart.

Jaws according to assembly drawing if not agreed otherwise.

röders
TEC



RXP 500 DS / DSC



RXP 501 DS / DSC

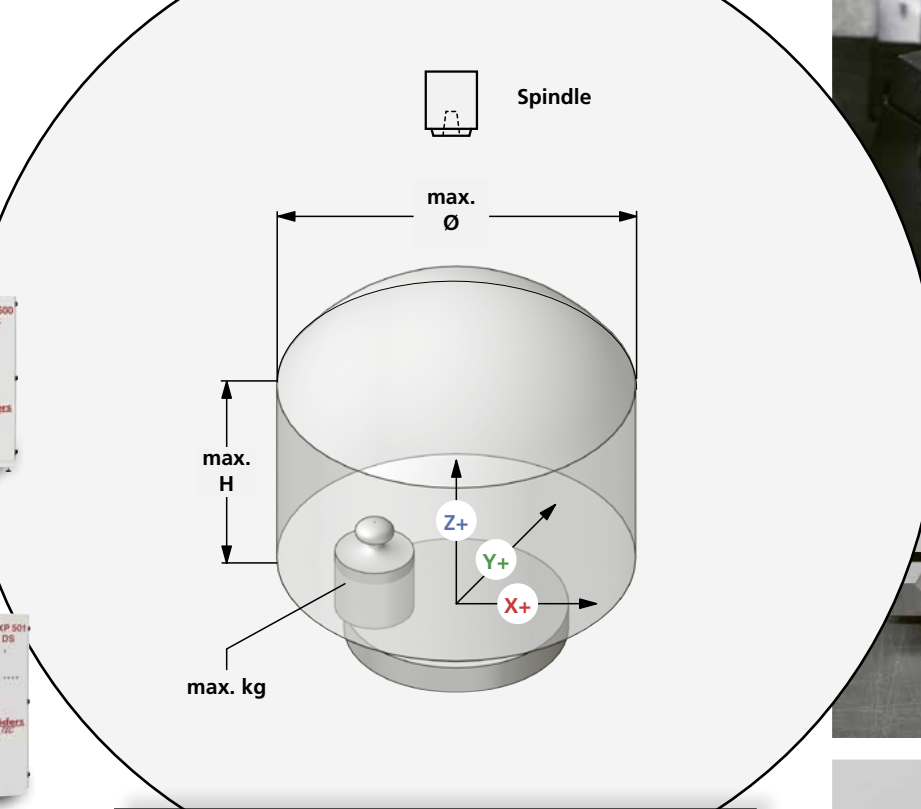

	X	Y	Z	max.		
				Ø	H	kg
RXP500DS	450 (X-316 X+134)	658 (Y-204 Y+454)	240	250	220	60
RXP500DSC	450 (X-316 X+134)	658 (Y-204 Y+454)	240	220	200	30
RXP501DS	500 (X-366 X+134)	700 (Y-230 Y+470)	300	250	200	60
RXP501DSC	500 (X-366 X+134)	700 (Y-230 Y+470)	300	220	200	30

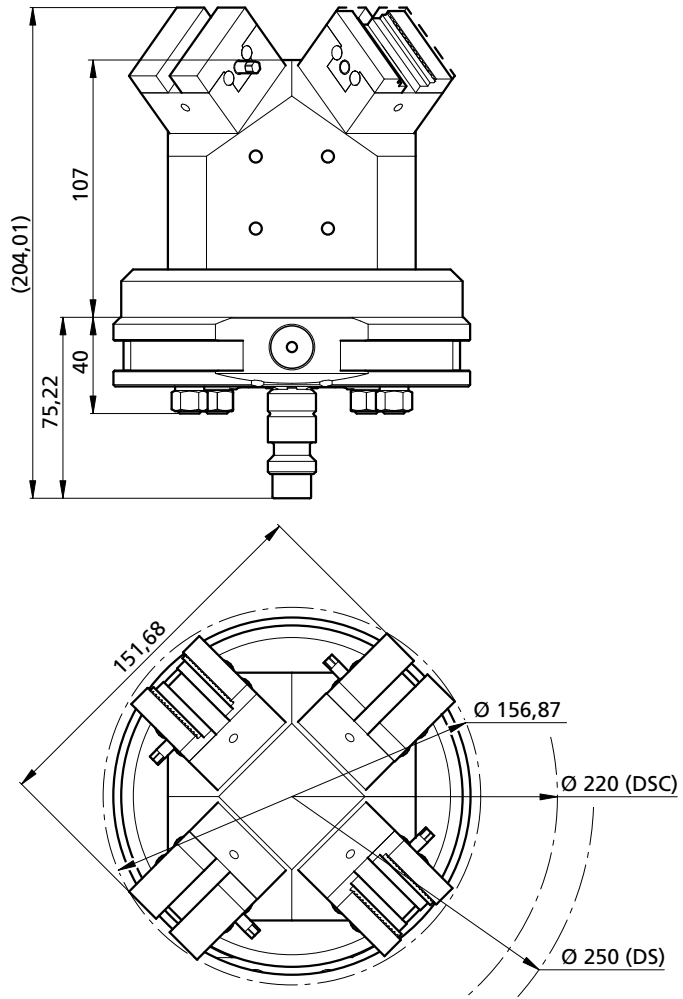
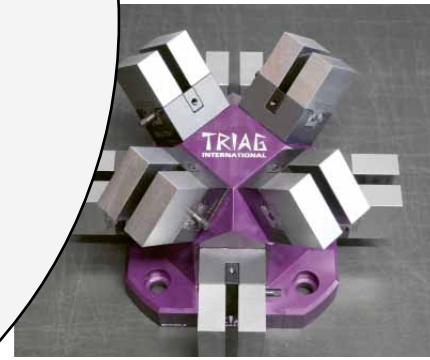

MICRO

Backenvarianten
Jaw variants

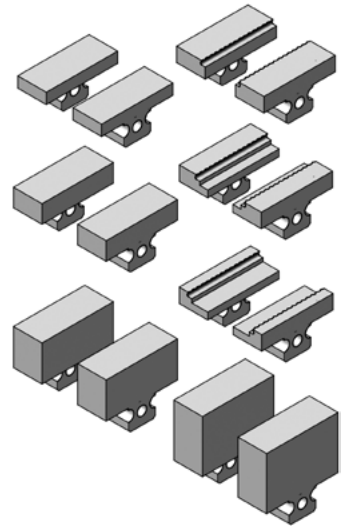

Mehr auf Seite 11
More on page 11

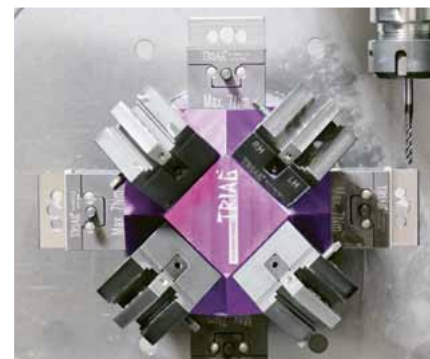



triCENTRO

5-Achs Mehrfachspannpyramide mit Erowa Schnittstelle
 5-axis multiple workholding pyramid with Erowa interface

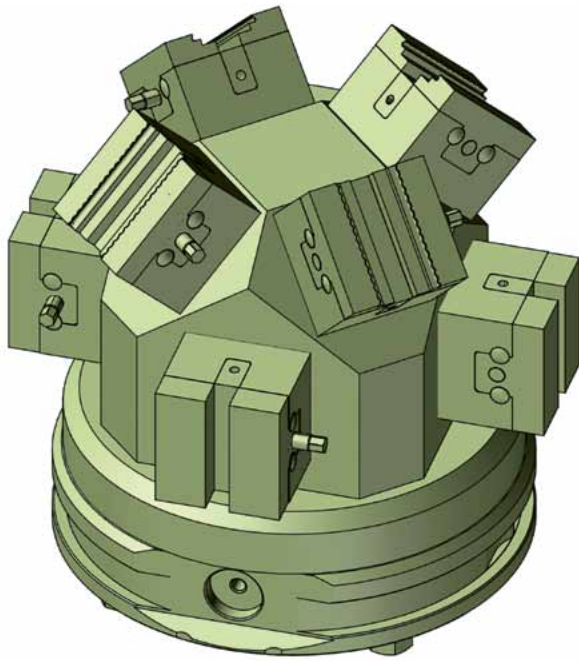

7 Backenvarianten
 Jaw variants

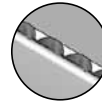

2,2 mm Direkt-Prägebacken
 2,2 mm Direct stamping jaws



«Sputnik» 5-Achs Mehrfachspannpyramide
 «Sputnik» 5-axis multiple workholding pyramid

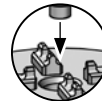

EROWA Schnittstelle
 EROWA interface



Beste Zugänglichkeit
 Best accessibility

Bestellschlüssel Order code	Bezeichnung Description	~ Kg	Spannstellen Clamping areas	Winkel Angle	Spannbereich Clamping area
RD500-SET3	Röders Set 3	8,7	8	45°	12 - 22

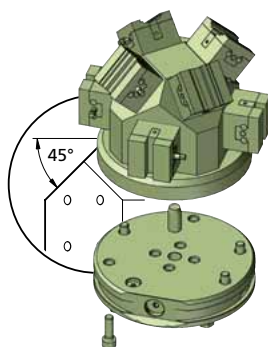

Drehmoment Torque		Spannkraft Workholding force		
Nm	(lb-ft)	~daN	~(lb)	~t
4	3	= 457	1'007	0,46
5	3,7	= 571	1'259	0,57
6	4,4	= 686	1'512	0,69
7	5,2	= 800	1'764	0,8

Backen gemäss Zusammenstellzeichnung falls nicht anders vereinbart.

Jaws according to assembly drawing if not agreed otherwise.

**röders
TEC**



RXP 500 DS / DSC



RXP 501 DS / DSC

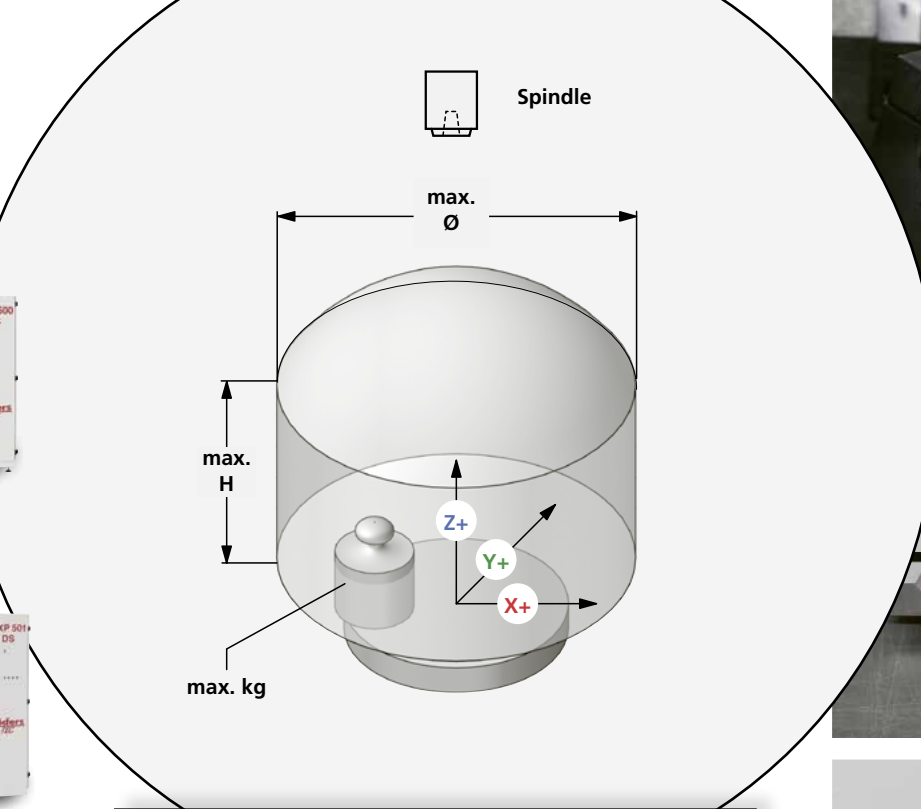

	X	Y	Z	max.		
				Ø	H	kg
RXP500DS	450 (X-316 X+134)	658 (Y-204 Y+454)	240	250	220	60
RXP500DSC	450 (X-316 X+134)	658 (Y-204 Y+454)	240	220	200	30
RXP501DS	500 (X-366 X+134)	700 (Y-230 Y+470)	300	250	200	60
RXP501DSC	500 (X-366 X+134)	700 (Y-230 Y+470)	300	220	200	30

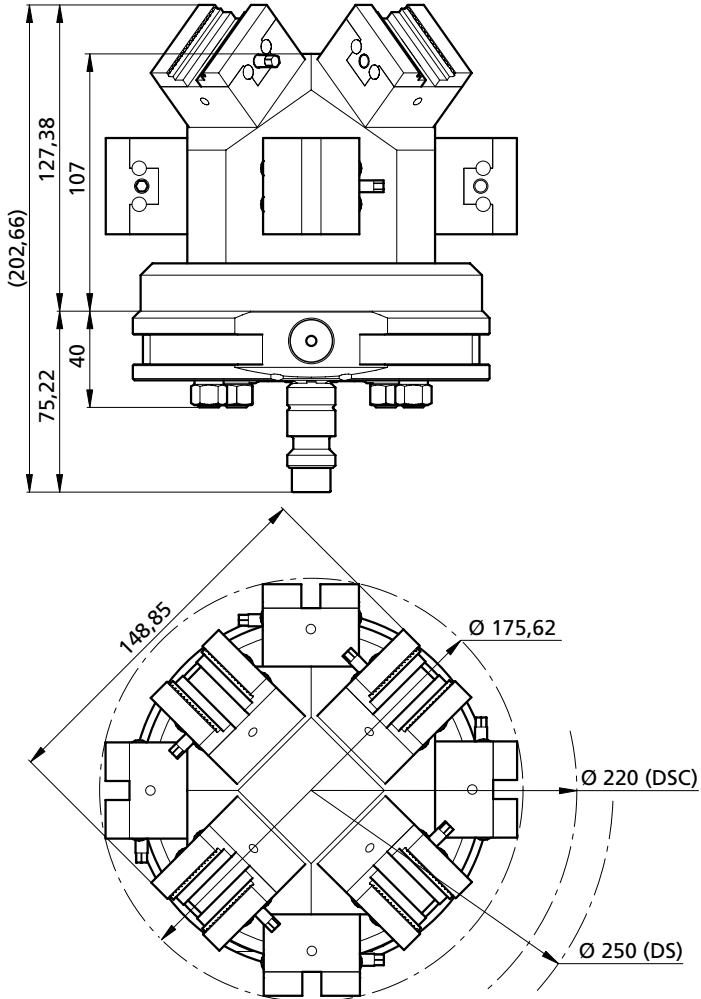
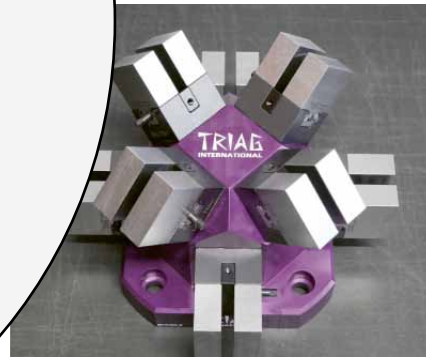

MICRO

Backenvarianten
Jaw variants

Mehr auf Seite 11
More on page 11

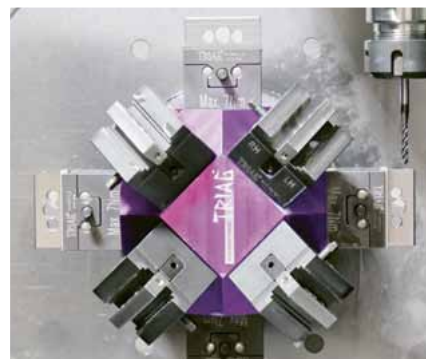
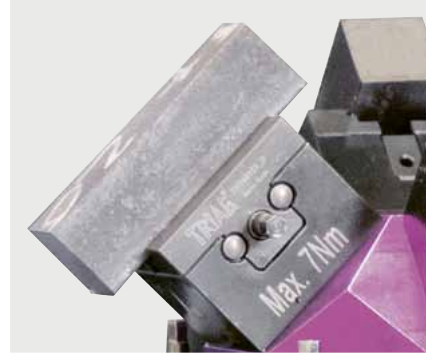



triCENTRO

Mini-Zentrischspanner inkl. Adapterflansch
 Mini self centering vises incl. adapter flange

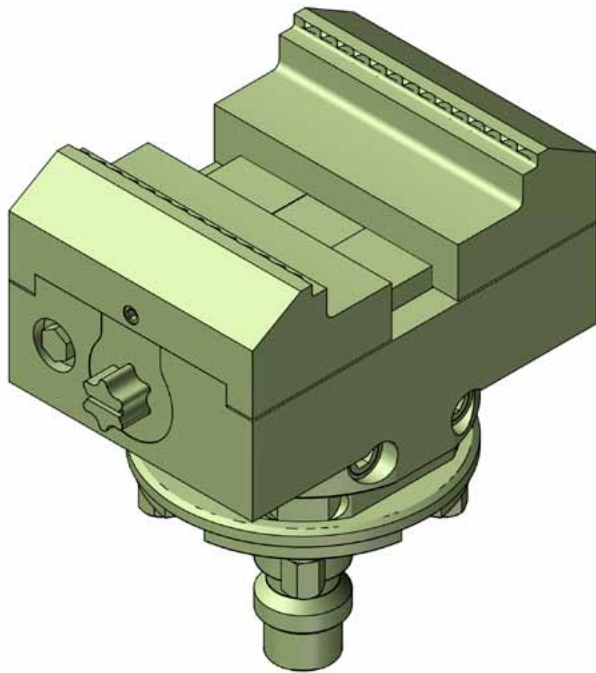

14

Backenvarianten
Jaw variants

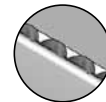

3mm Direkt-Prägebacken
3mm Direct stamping jaws

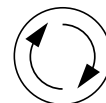

Backen-Schnellwechselsystem
Quick-change jaw system



Beste Zugänglichkeit
Best accessibility

Bestellschlüssel <i>Order code</i>	Bezeichnung <i>Description</i>	~ Kg	Spannstellen <i>Clamping areas</i>	Spannbereich <i>Clamping area</i>
RD500-SET4	Röders Set 4	3,02	1	44 - 64



Drehmoment <i>Torque</i>		Spannkraft <i>Workholding force</i>		
Nm	(lb-ft)	~daN	~(lb)	~t
10	7,4	= 200	440	0,2
20	14,8	= 500	1'102	0,5
30	22,2	= 1'000	2'204	1,0
40	29,6	= 1'300	2'866	1,3
50	37,0	= 1'600	3'527	1,6

Backen gemäss Zusammenstellzeichnung falls nicht anders vereinbart.

Jaws according to assembly drawing if not agreed otherwise.

röders
TEC



RXP 500 DS / DSC



RXP 501 DS / DSC

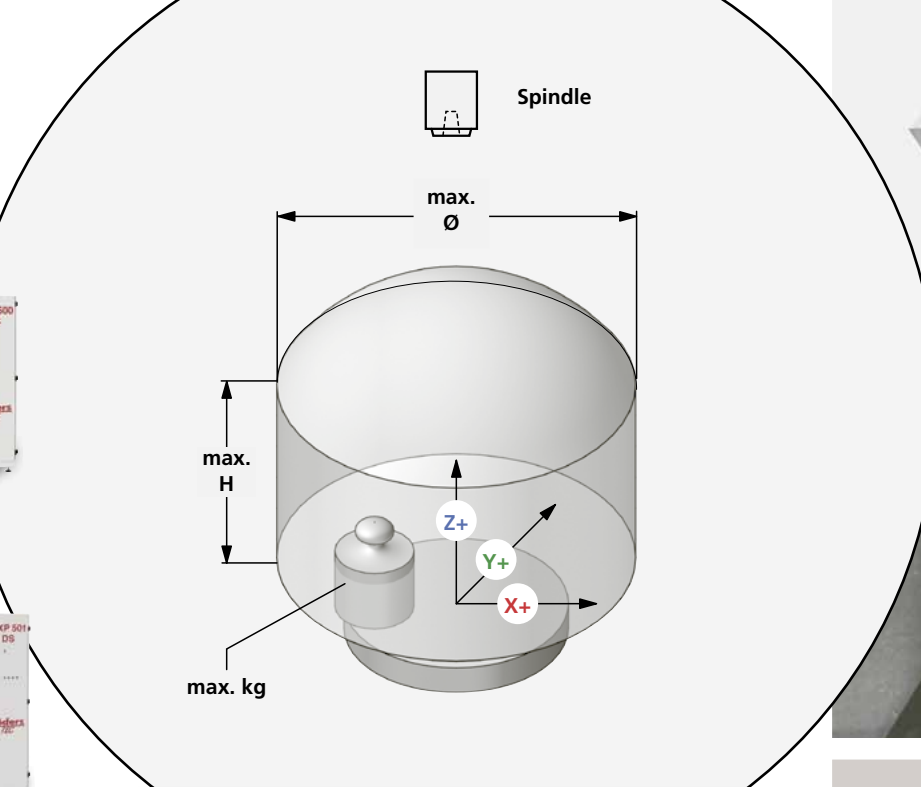

	X	Y	Z	max.		
				Ø	H	kg
RXP500DS	450 (X-316 X+134)	658 (Y-204 Y+454)	240	250	220	60
RXP500DSC	450 (X-316 X+134)	658 (Y-204 Y+454)	240	220	200	30
RXP501DS	500 (X-366 X+134)	700 (Y-230 Y+470)	300	250	200	60
RXP501DSC	500 (X-366 X+134)	700 (Y-230 Y+470)	300	220	200	30

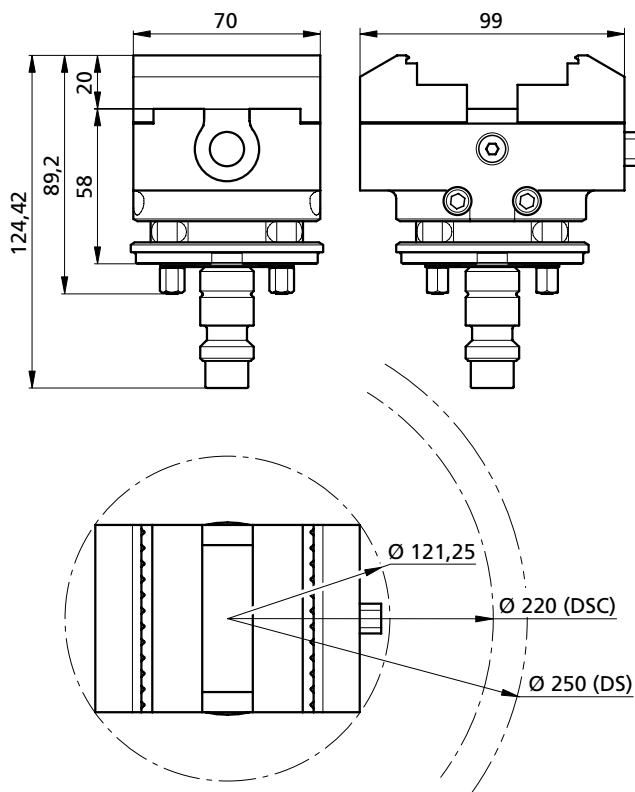
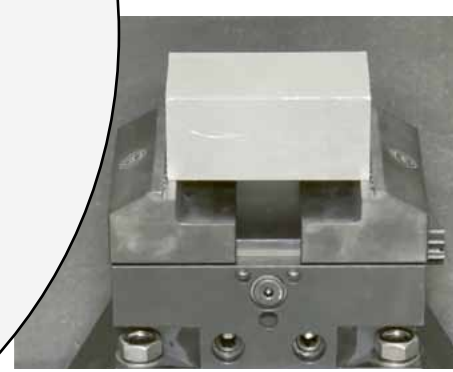
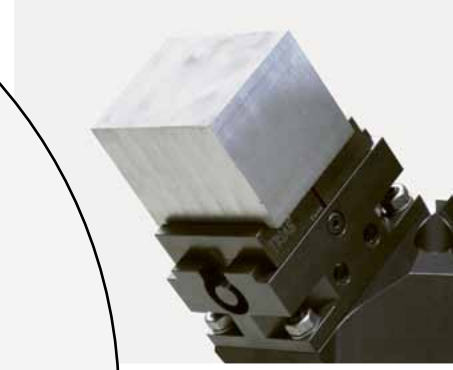

MINI

Backenvarianten
Jaw variants

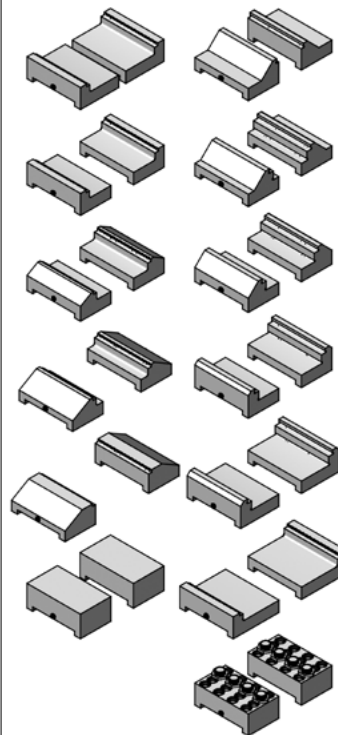

Mehr auf Seite 10
More on page 10

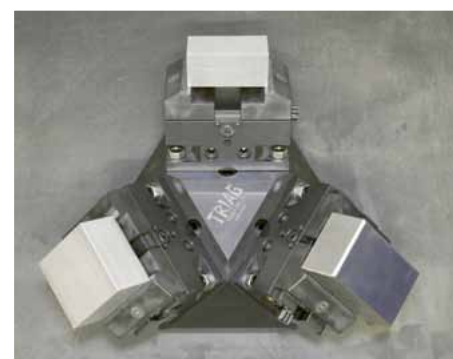

Drehmoment Torque		Spannkraft Workholding force		
Nm	(lb-ft)	~daN	~(lb)	~t
10	7,4	= 200	440	0,2
20	14,8	= 500	1'102	0,5
30	22,2	= 1'000	2'204	1,0
40	29,6	= 1'300	2'866	1,3
50	37,0	= 1'600	3'527	1,6

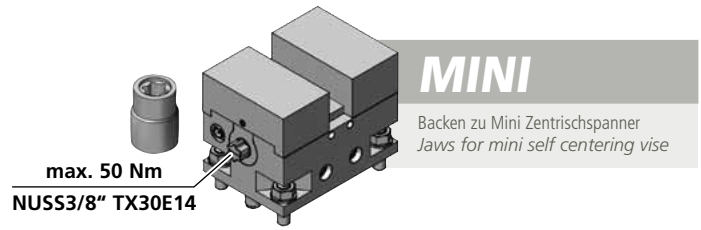

Prägebacken Stamping jaws	B175-26 C = 70 H = 20 L = 40 i 57HRC Spannbereich / Clamping range 6-26 mm	B175-45 C = 70 H = 20 L = 40 i 57HRC Spannbereich / Clamping range 25-45 mm	B175-64 C = 70 H = 20 L = 40 i 57HRC Spannbereich / Clamping range 44-64 mm
	B175-83 C = 70 H = 20 L = 40 i 57HRC Spannbereich / Clamping range 63-83 mm	B175-102 C = 70 H = 20 L = 50 i 57HRC Spannbereich / Clamping range 83-102 mm	B175-121 C = 70 H = 20 L = 60 i 57HRC Spannbereich / Clamping range 101-121 mm
	B173-26 C = 70 H = 24 L = 40 i HV700 x 0,2 mm Spannbereich / Clamping range 6-26 mm	B173-45 C = 70 H = 24 L = 40 i HV700 x 0,2 mm Spannbereich / Clamping range 25-45 mm	B173-64 C = 70 H = 24 L = 40 i HV700 x 0,2 mm Spannbereich / Clamping range 44-64 mm
B173-83 C = 70 H = 24 L = 40 i HV700 x 0,2 mm Spannbereich / Clamping range 63-83 mm	B173-102 C = 70 H = 24 L = 50 i HV700 x 0,2 mm Spannbereich / Clamping range 82-102 mm	B170, B172 (weich / soft) C = 70 H = 24 L = 40 i HV700 x 0,2 mm Spannbereich / Clamping range 0-20 mm	
B176-80 *PRG1003M8 C = 70 H = 24 L = 40 *PRG1003M8 Optional erhältlich / Optional accessory Spannbereich / Clamping range 8-80 mm	Zum Erstellen Ihrer individuellen Formbacke: Maximalen Bearbeitungsprofiltiefe If a dedicated jaw is being machined: Max. workpiece machining depth 		

Für mehr Informationen, Zubehör oder Backensets > [Gesamtkatalog/triCENTRO](#)
 For further informations, accessories or jaw sets > [General catalogue/triCENTRO](#)



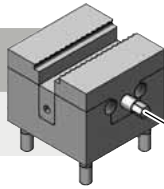

MICRO

Backen zu micro Zentrischspanner
Jaws for mini self centering vise

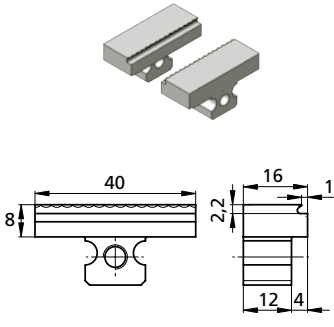
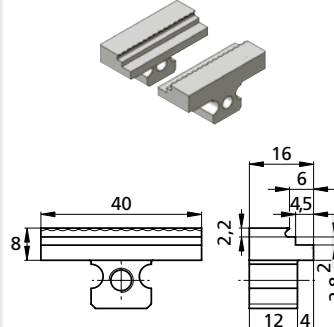
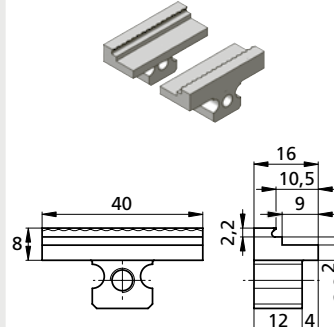

max. 7 Nm
NUSS 1/4" 4,5mm

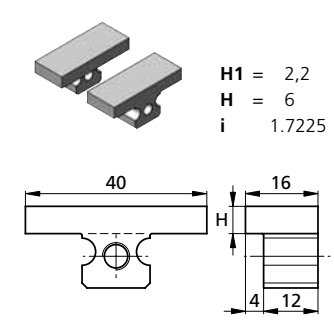
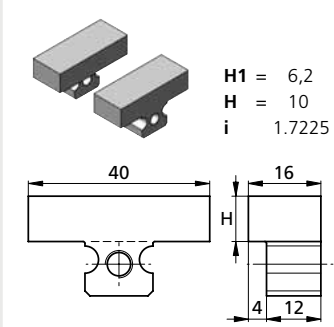
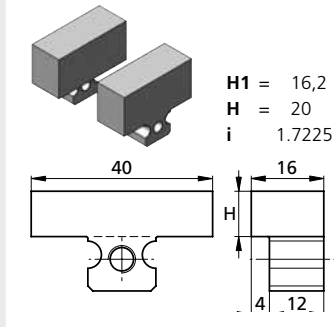
Drehmoment Torque		Spannkraft Workholding force		
Nm	(lb-ft)	~daN	~(lb)	~t
4	3	= 457	1'007	0,46
5	3,7	= 571	1'259	0,57
6	4,4	= 686	1'512	0,69
7	5,2	= 800	1'764	0,8

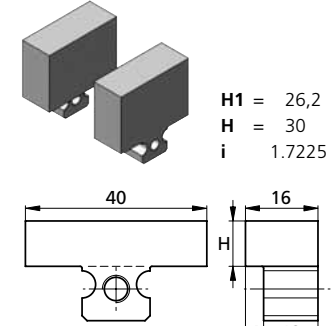
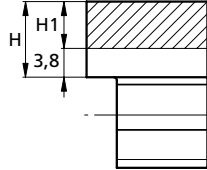
	B190-13	B190-22	B190-31
 Prägebacken Stamping jaws	Spannbereich / Clamping range 3-13 mm 	Spannbereich / Clamping range 12-22 mm 	Spannbereich / Clamping range 21-31 mm 
 Formbacke weich Dedicated jaws	Spannbereich / Clamping range 0-10 mm 	Spannbereich / Clamping range 0-10 mm 	Spannbereich / Clamping range 0-10 mm 
 Formbacke weich Dedicated jaws	Spannbereich / Clamping range 0-10 mm 	<p>H1: Zum Erstellen Ihrer individuellen Formbacke: Schnittzeichnung zum Ermitteln der max. Bearbeitungsprofiltiefe</p> <p>H1: If a dedicated jaw is being machined: Sectional drawing to determine the maximum machining depth.</p> 	

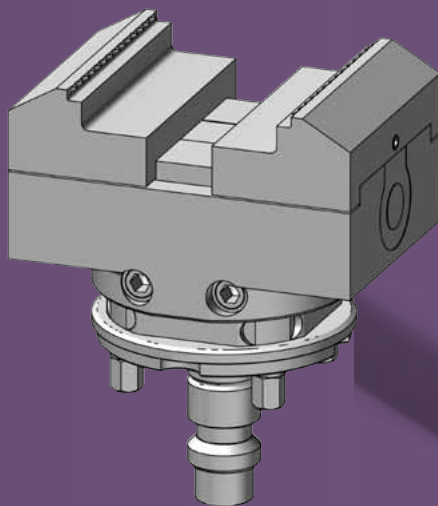
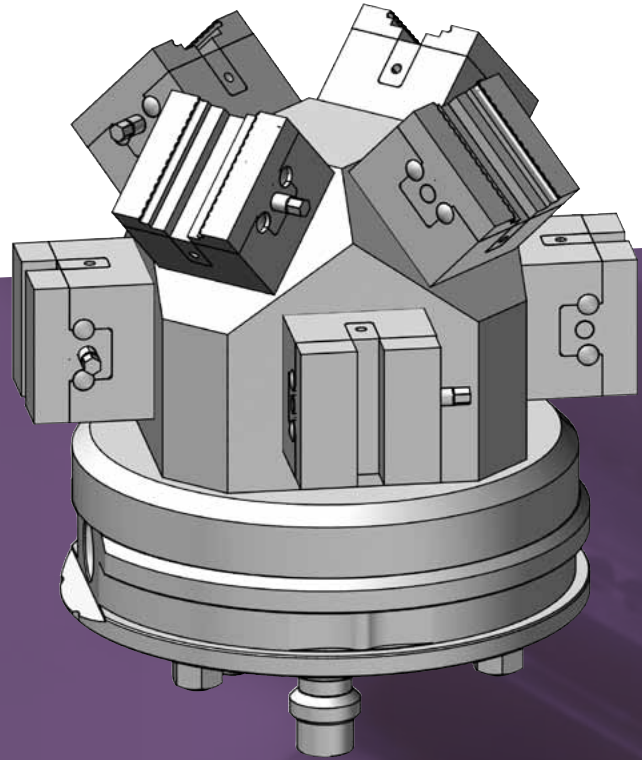
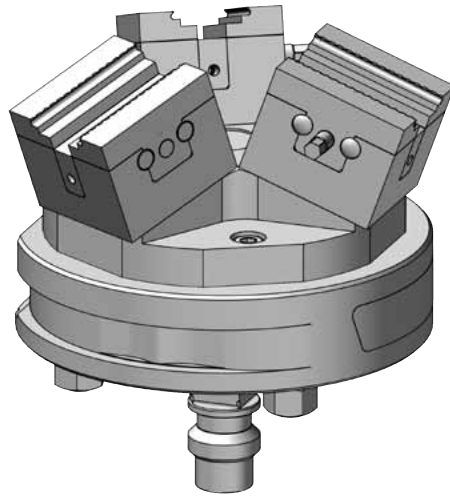

Triag International AG

Bösch 84 CH-6331 Hünenberg

☎ +41 41 727 27 77

✉ spannen@triag-int.ch

✉ clamping@triag-int.ch

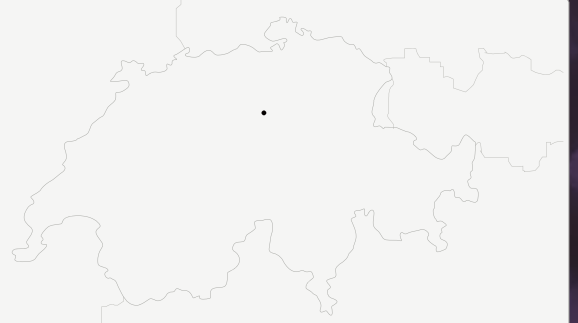

Mass- und Konstruktionsänderungen
bleiben uns vorbehalten. *We reserve
the right to modify dimensions and
structural design.*

triag-int.ch

Official Website



11
21