



Maschinenspezifische Spannlösungen  
*Machine specific workholding solutions*

**swissMODULAR**



# TRIAG

## INTERNATIONAL

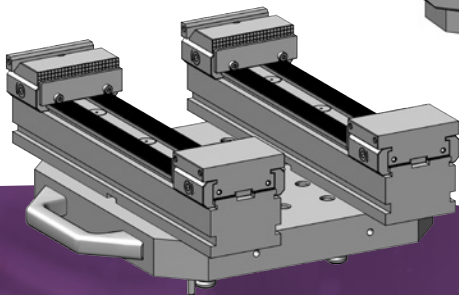
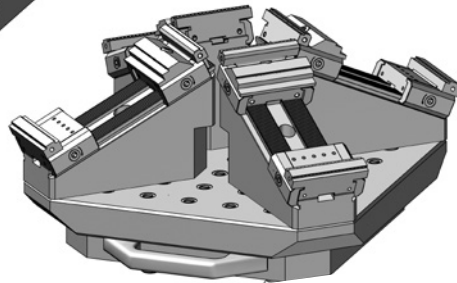
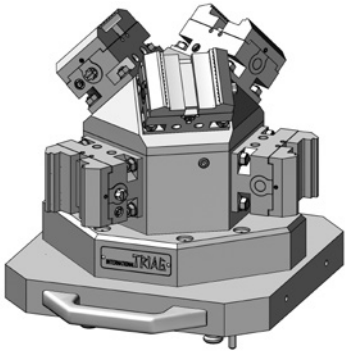

RXP 601DS  
RXP 601DSH

**röders**  
*TEC*



# triCENTRO

Mechanische Zentrischspanner auf einem Pyramidenspannblock  
*Mechanical self centring vises on a pyramid clamping block*



Mehrfachspannsystem  
*Multiple workholding system*

3D  
 MODULAR

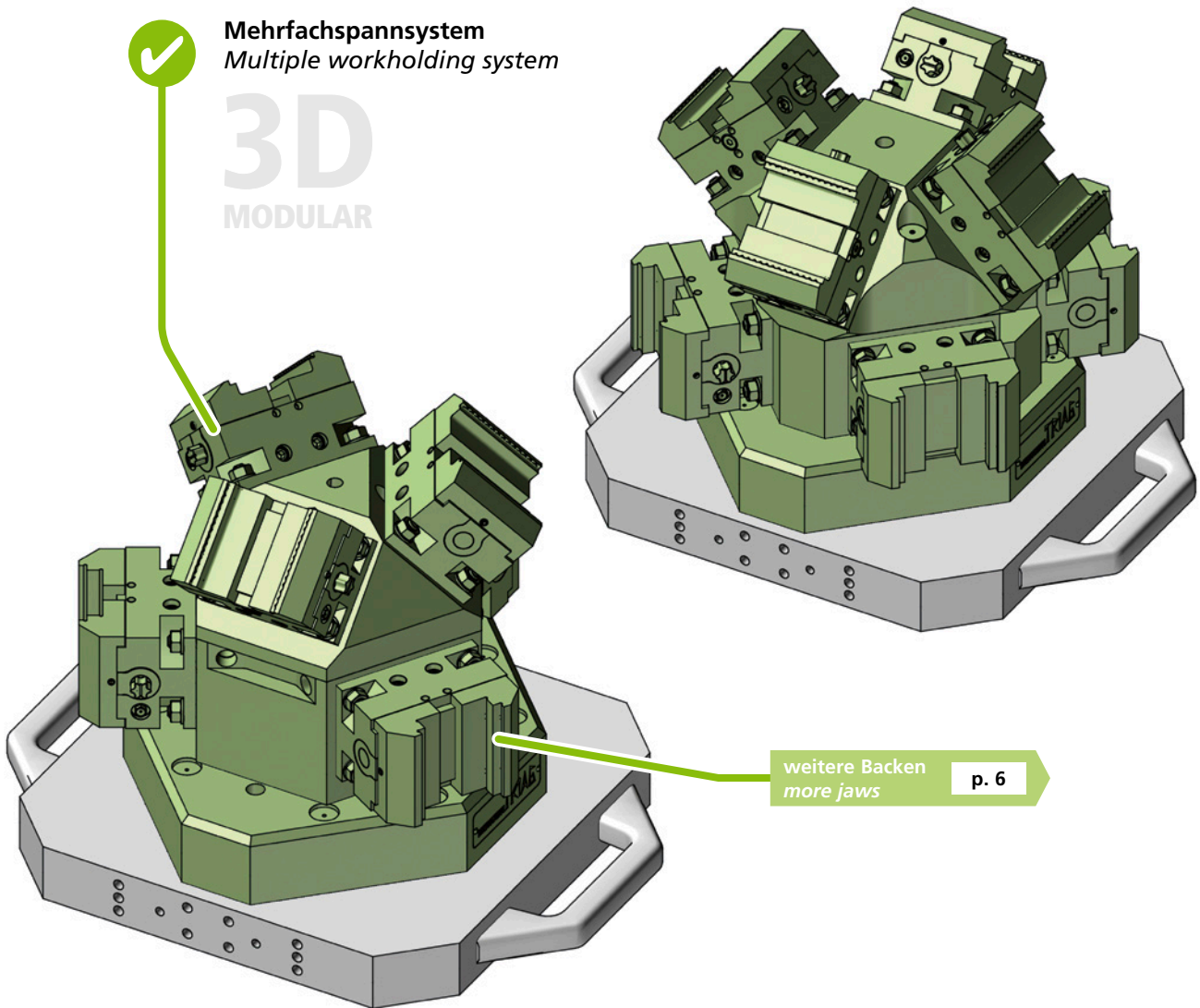

Bestellnummer <i>Order code</i>	Bezeichnung <i>Description</i>	~ Kg	Spannstellen <i>Clamping areas</i>	Spannsystem <i>Clamping system</i>	Maschinentisch <i>Palette</i>
RXP601DS(H)-SET1	RXP601DS(H) Set 1	61	6	triCENTRO	400 x 400
RXP601DS(H)-SET2	RXP601DS(H) Set 2	75	8	triCENTRO	400 x 400

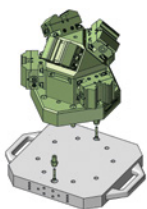

RXP601DS(H)-SET1

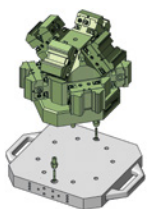

RXP601DS(H)-SET2





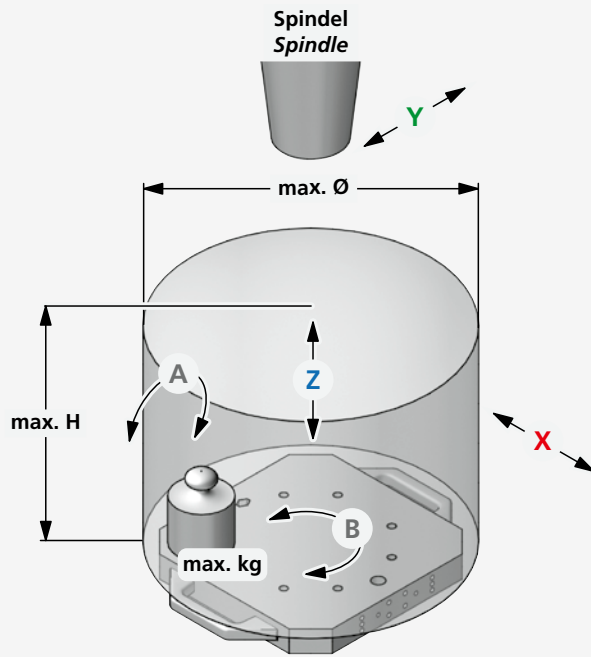

	X	Y	Z	max.		
				Ø	H	kg
RXP601DS	520 (X-309 X+211)	635 (Y-300 Y+335)	400 (Z+51 Z+451)	440	451	100
RXP601DSH	540 (X-340 X+200)	635 (Y-310 Y+325)	400 (Z+155 Z+555)	500	555	200

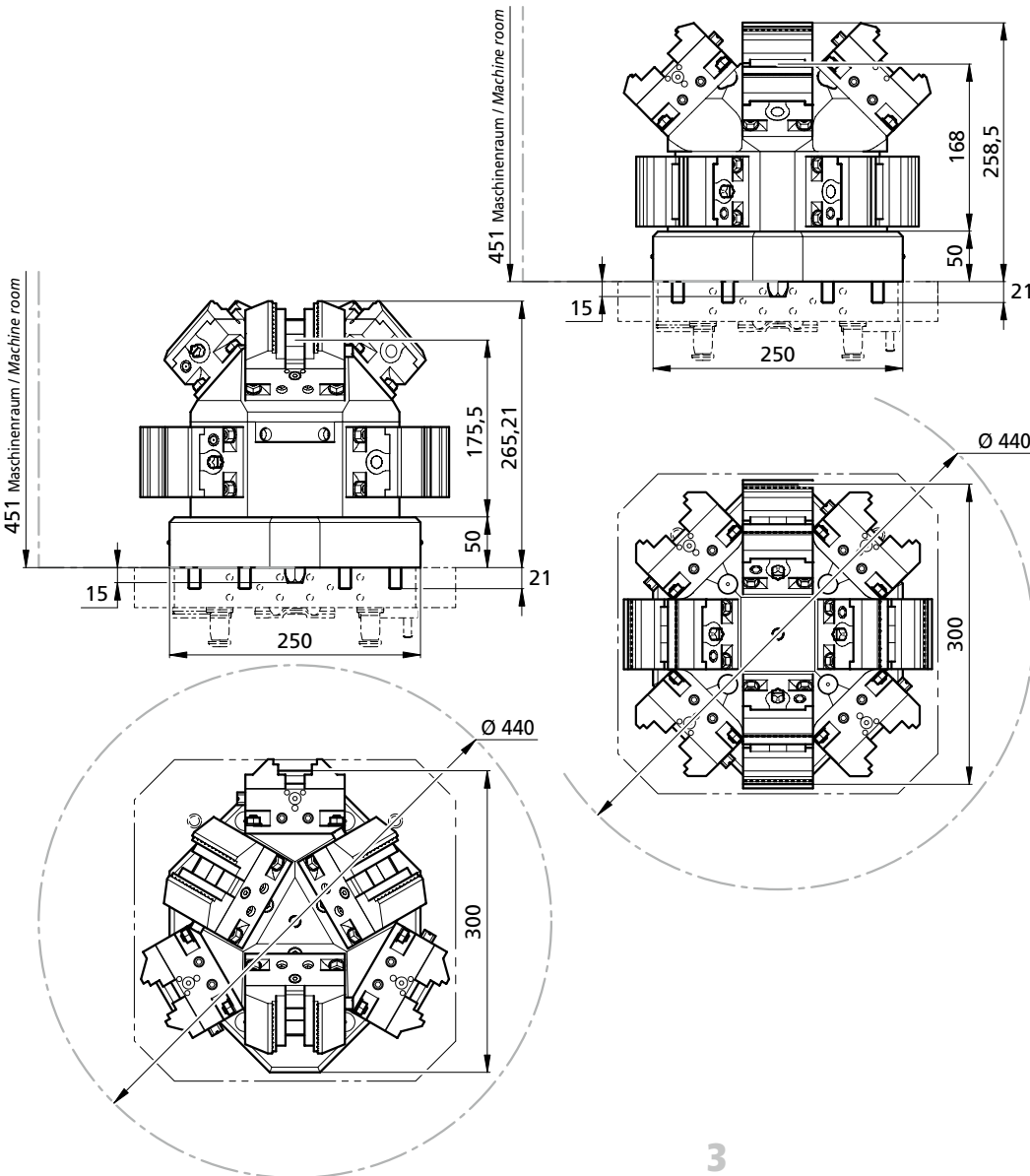
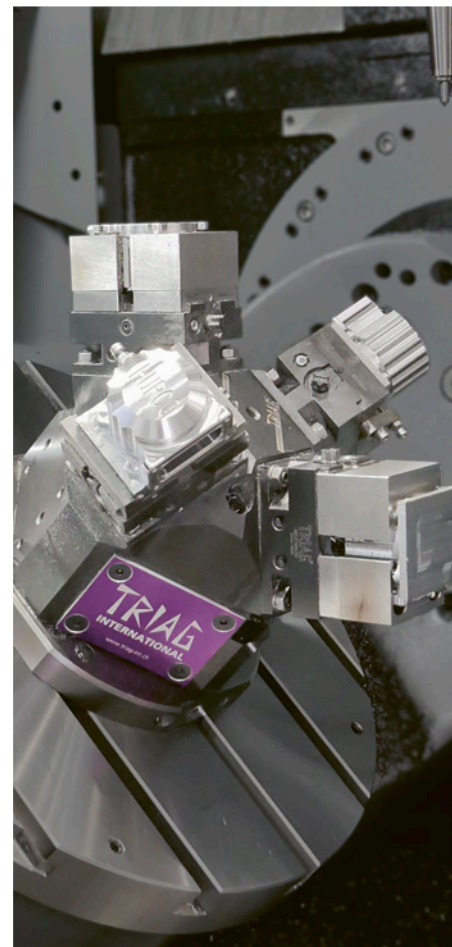
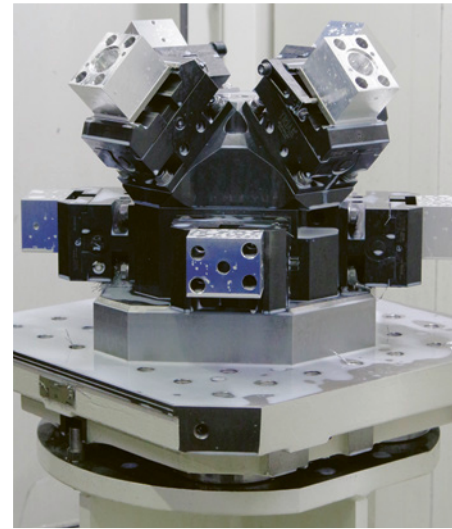
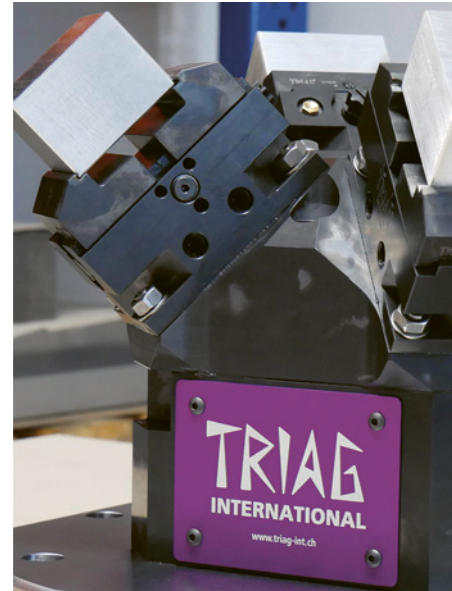



# powerCLAMP

Modulares Spannsystem  
Modular workholding system



Mehrfachspannsystem  
Multiple workholding system

3D  
MODULAR

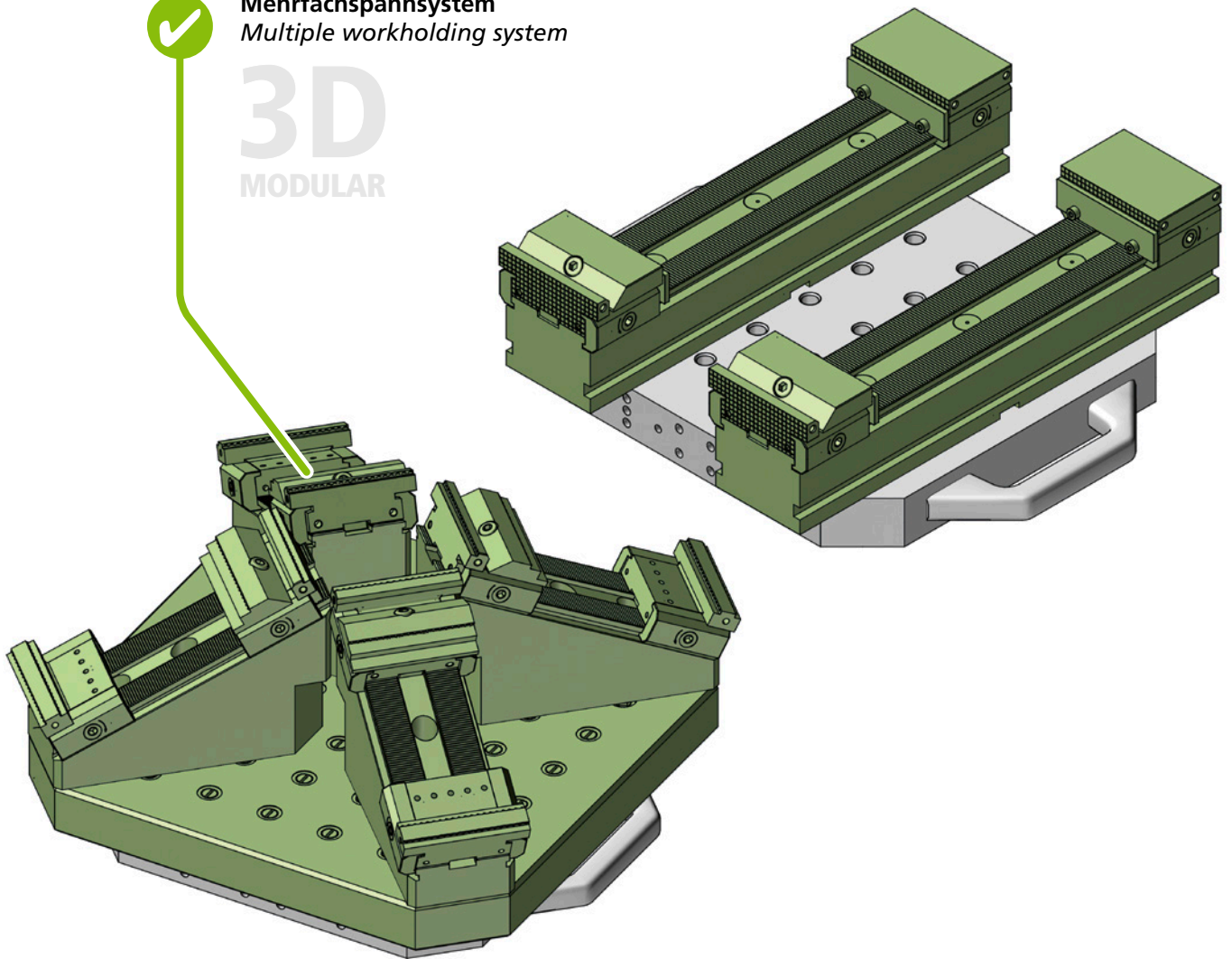

Bestellnummer Order code	Bezeichnung Description	~ Kg	Spannstellen Clamping areas	Spannsystem Clamping system	Maschinentisch Palette
 <b>RXP601DS(H)-SET3</b>	RXP601DS(H) Set 3	28	2	<b>powerCLAMP</b>	400 x 400
 <b>RXP601DS(H)-SET4</b>	RXP601DS(H) Set 4	97	4	<b>powerCLAMP</b>	400 x 400

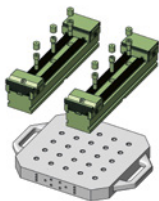

**RXP601DS(H)-SET3**

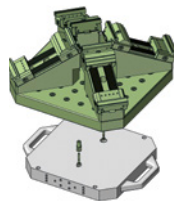

**RXP601DS(H)-SET4**







**röders**  
TEC

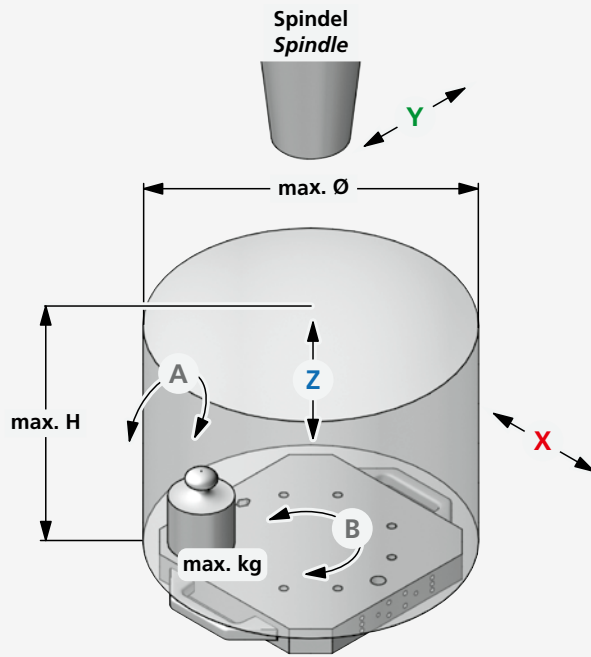

	X	Y	Z	max.		
				Ø	H	kg
RXP601DS	520 (X-309 X+211)	635 (Y-300 Y+335)	400 (Z+51 Z+451)	440	451	100
RXP601DSH	540 (X-340 X+200)	635 (Y-310 Y+325)	400 (Z+155 Z+555)	500	555	200

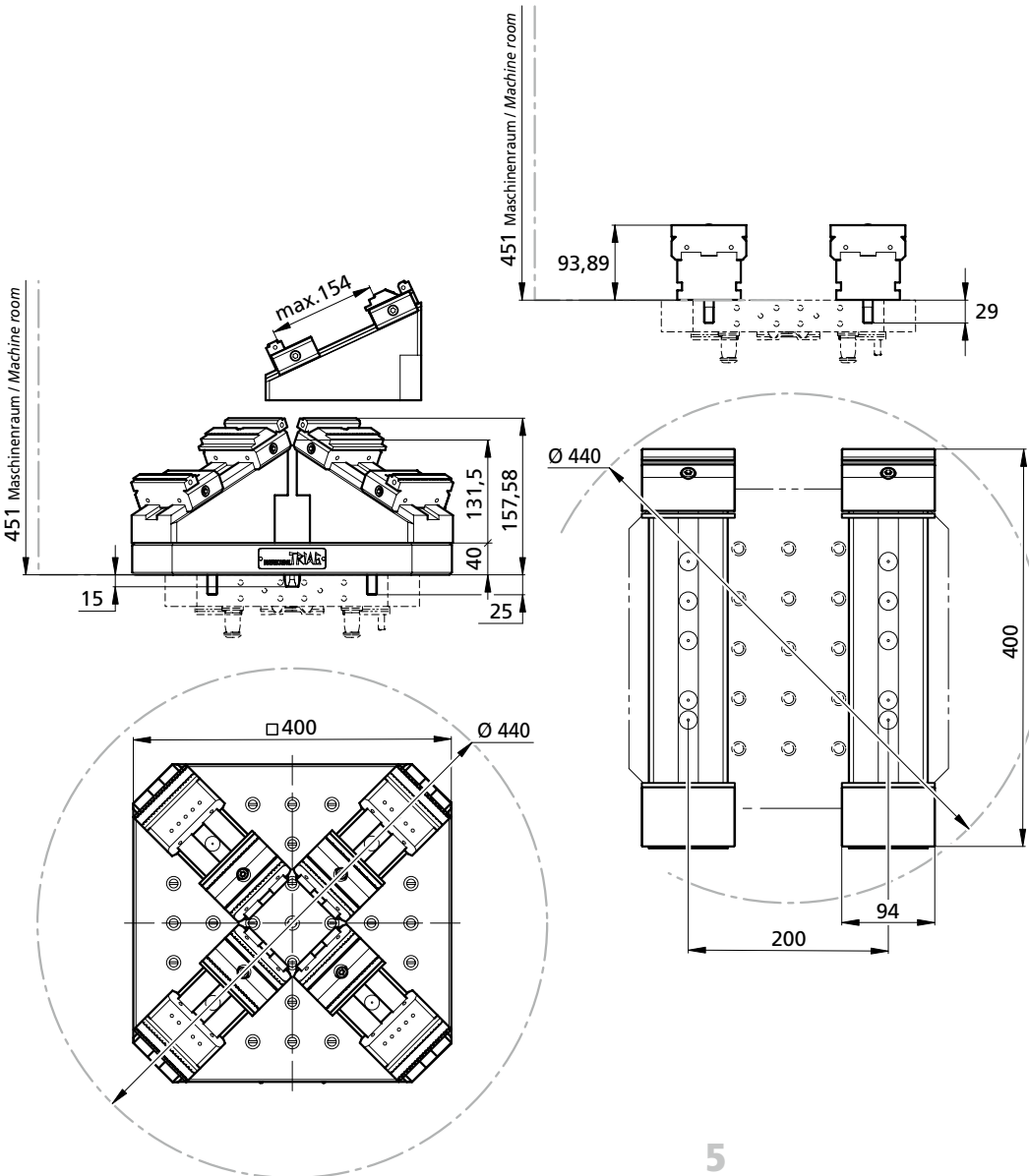
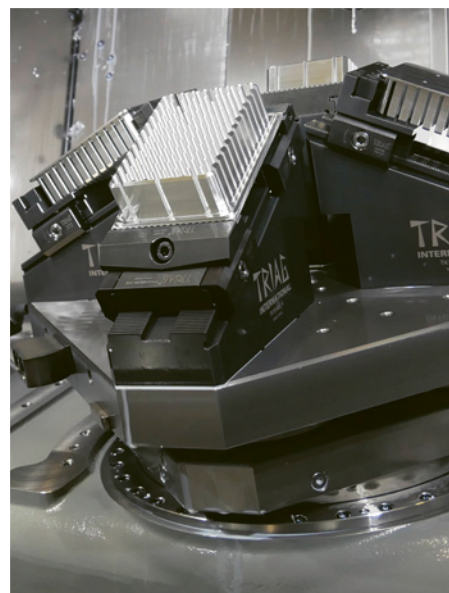
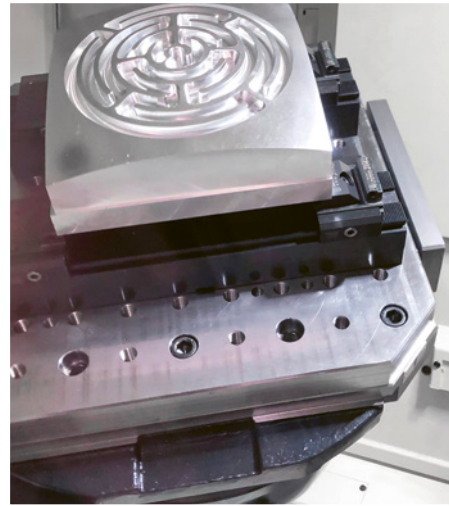
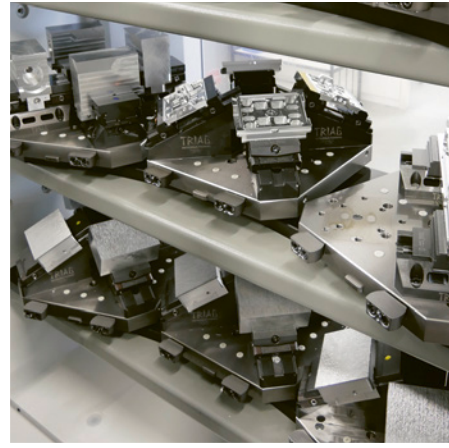



# powerCLAMP

Modulares Spannsystem  
Modular workholding system



# Gründe für / reasons for 10 powerCLAMP

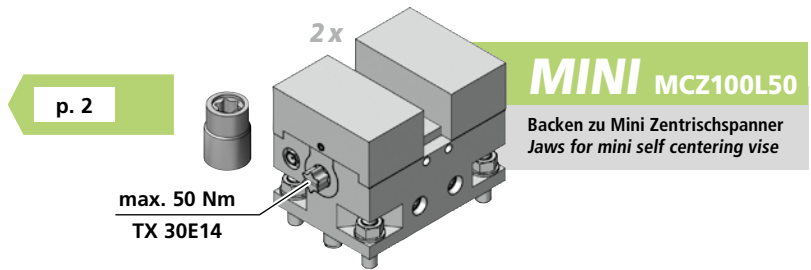

Spannbereich / Clamping range		Spannbereich / Clamping range		Spannbereich / Clamping range		Spannbereich / Clamping range	
<b>B175-26</b>	6 - 26 mm	<b>B175-45</b>	25 - 45 mm	<b>B175-64</b>	44 - 64 mm	<b>B170, B172 (weich/soft)</b> 0 - 20 mm	
i 57HRC		i 57HRC		i 57HRC		i HV700x0,2mm	
Spannbereich / Clamping range		Spannbereich / Clamping range		Spannbereich / Clamping range		<b>Zum Erstellen Ihrer individuellen Formbacke:</b> Maximalen Bearbeitungsprofiltiefe <b>If a dedicated jaw is being machined:</b> Max. workpiece machining depth 	
<b>B175-83</b>	63 - 83 mm	<b>B175-102</b>	82 - 102 mm	<b>B175-121</b>	101 - 121 mm		
i 57HRC		i 57HRC		i 57HRC			
Spannbereich / Clamping range		Spannbereich / Clamping range		Spannbereich / Clamping range		Spannbereich / Clamping range	
<b>B173-26</b>	6 - 26 mm	<b>B173-45</b>	25 - 45 mm	<b>B173-64</b>	44 - 64 mm	<b>B176-80</b> 8 - 80 mm	
i HV700x0,2mm		i HV700x0,2mm		i HV700x0,2mm		i HV700x0,2mm	
Spannbereich / Clamping range		Spannbereich / Clamping range				<b>PRG1003M8</b> Optional erhältlich Optional accessory 	
<b>B173-83</b>	63 - 83 mm	<b>B173-102</b>	82 - 102 mm				
i HV700x0,2mm		i HV700x0,2mm					

Drehmoment Torque		Spannkraft Workholding force	
10 Nm	lb-ft 7,4	= 0,2 t	200 daN
20 Nm	lb-ft 14,8	= 0,5 t	500 daN
30 Nm	lb-ft 22,2	= 1,0 t	1'000 daN
40 Nm	lb-ft 29,6	= 1,3 t	1'300 daN
50 Nm	lb-ft 37,0	= 1,6 t	1'600 daN

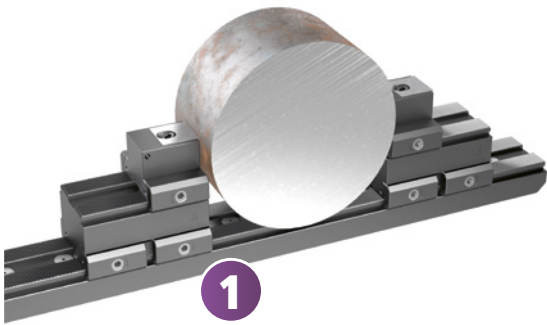

**1**

3D-Modularität - Hohes Mass an Flexibilität  
Für 3-, 4-, 5-Achsen- und horizontale Maschinen  
3D-Modularity - High degree of flexibility  
For 3-, 4-, 5-axes- and horizontal machines

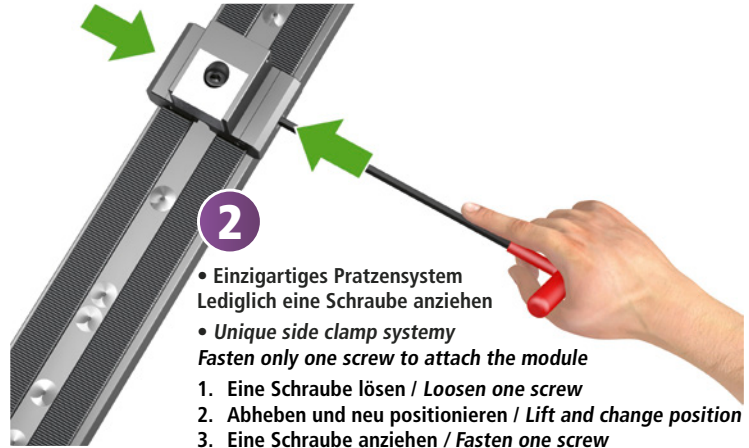

**2**

• Einzigartiges Pratzensystem  
Lediglich eine Schraube anziehen  
• Unique side clamp system  
Fasten only one screw to attach the module

1. Eine Schraube lösen / Loosen one screw
2. Abheben und neu positionieren / Lift and change position
3. Eine Schraube anziehen / Fasten one screw

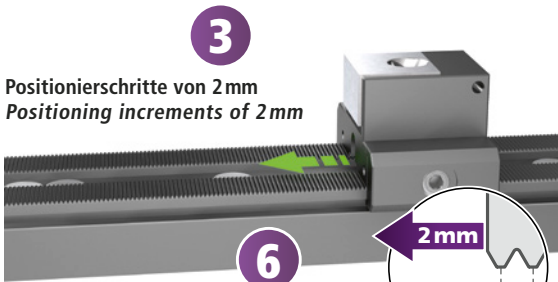

**3**

Positionierschritte von 2mm  
Positioning increments of 2mm

**6**

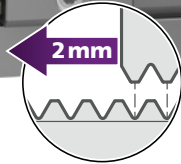

Präzise und zuverlässige Schnittstelle  
Precise and reliable interface

Kann als mechanisches Nullpunktsystem genutzt werden  
Can be used as mechanical zero point system



**4**

Einfache, schnelle Handhabung  
Easy and quick handling

**5**

Leichtgewichtig  
Lightweight

Modul mit zwei Fingern abhebbar  
Module with two fingers liftable

**7**

4 Schienenhöhen und diverse Monoblocks erhältlich  
4 Baserails heights and various monoblocks available

4 Baserails heights and various monoblocks available

Verschiedene Längen und Varianten erhältlich  
Different lengths and versions available

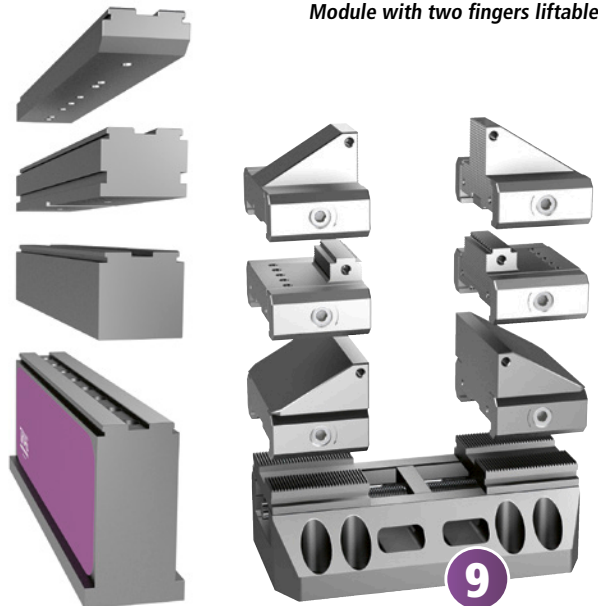

**8**

Keine spänefüllenden T-Nuten  
No chip catching T-slots

Einfache und schnelle Reinigung mit einem Wisch  
Easy and fast cleaning with one wipe

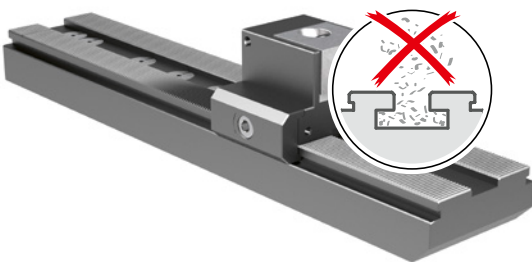

**9**

Kompatibel mit Zentrischspanner «ZSM»  
Compatible with self centering vise

Ausgestattet mit einer powerCLAMP Schnittstelle (Produktlinie: triCENTRO)  
Equipped with a powerCLAMP interface (product line: triCENTRO)

**10**

Mehr als 200 Module und 120 Backen & Grosses Standard-Zubehörsortiment  
More than 200 modules and 120 jaws & Wide range of standard accessories

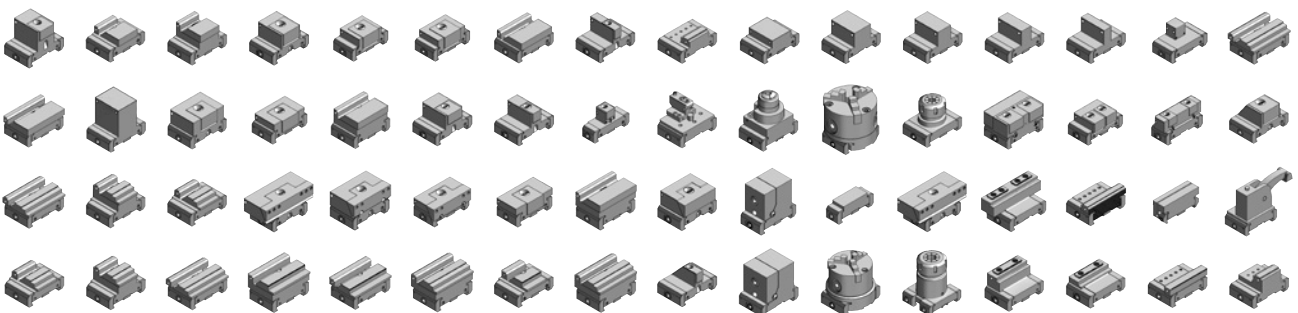



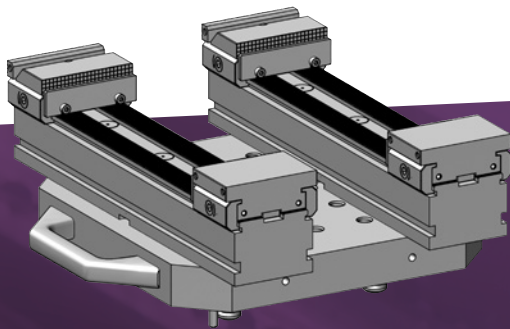
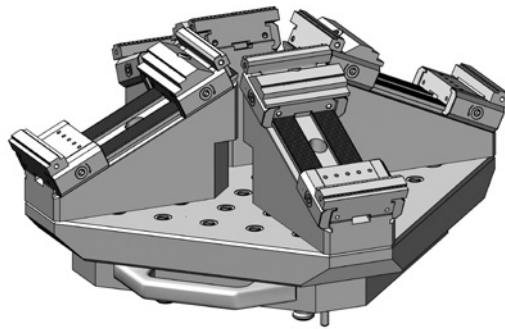
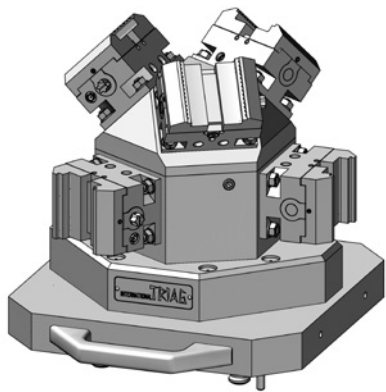

## Triag International AG

Bösch 84 CH-6331 Hünenberg

☎ +41 41 727 27 77

✉ [spannen@triag-int.ch](mailto:spannen@triag-int.ch)

✉ [clamping@triag-int.ch](mailto:clamping@triag-int.ch)

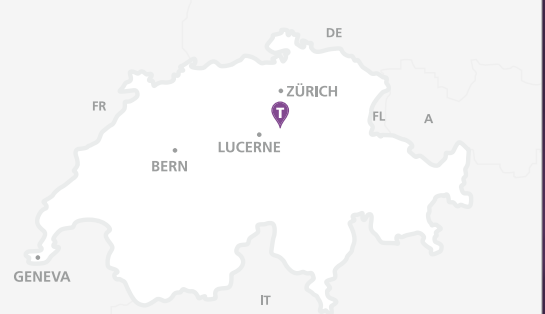

Mass- und Konstruktionsänderungen  
bleiben uns vorbehalten. *We reserve  
the right to modify dimensions and  
structural design.*

# triag-int.ch

Official Website



11  
22