



**swiss**   
**MODULAR**<sup>®</sup>

**TRIAG**  
INTERNATIONAL



**spaceGRIP**

**EMO**

**NEWS**

**2023**



Unsere neue Marke  
Our new brand

**swiss**   
**MODULAR**<sup>®</sup>

# we have rebranded



**swiss**   
**MODULAR**<sup>®</sup>  
BY TRIAG INTERNATIONAL AG

**TRIAG**  
INTERNATIONAL

Triag International AG  
launcht die neue Marke  
swissMODULAR.  
Die Marke umfasst das  
gesamte Sortiment an  
Spannsystemen und  
Mineralgusstürmen

**2023**

*Triag International AG has launched the brand swissMODULAR. The new brand includes the whole range of clamping systems and epoxy mineral tombstones.*



Zentrischspanner mit Schnellwechselbacken  
*Self centering vise with quick-change jaws*

**swiss**   
**MODULAR**<sup>®</sup>

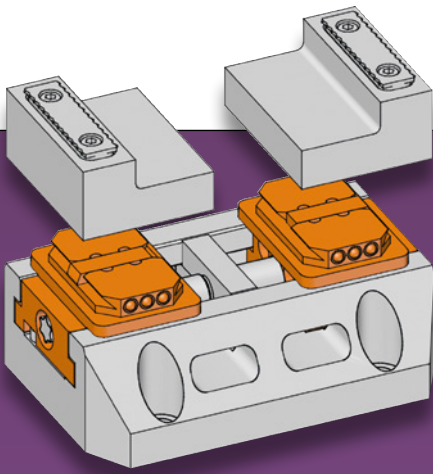

## ZSQ (P)

**Zentrischspanner mit Schnellwechselbacken und Spannkrafterhaltung durch Nachfederung, mit (P) / ohne Pendelfunktion**

*Self centering vises with quick change jaws and spring loaded mechanism to maintain clamping force, with (P) / without pendulum function*

Spannbereich  
*Clamping area*      **8 - 260 mm**

Max. Spannkraft  
*Max. Clamping force*      **1600 daN** (50 Nm)

Abmessungen  
*Dimensions*      **( ) x 120 x 100 mm**

**160**  
mm



**180**  
mm



**200**  
mm



**300**  
mm



**2**

**Backenvarianten**  
*Jaw variants*



**3 mm Direkt-Prägebacken**  
*3 mm direct stamping jaws*



**Einseitige Spannkrafterhaltung durch Nachfederung**  
*One sided spring loaded mechanism to maintain clamping force*



**Schnellwechselbacke mit Klick-Funktion**  
*Quick change jaw with click-function*



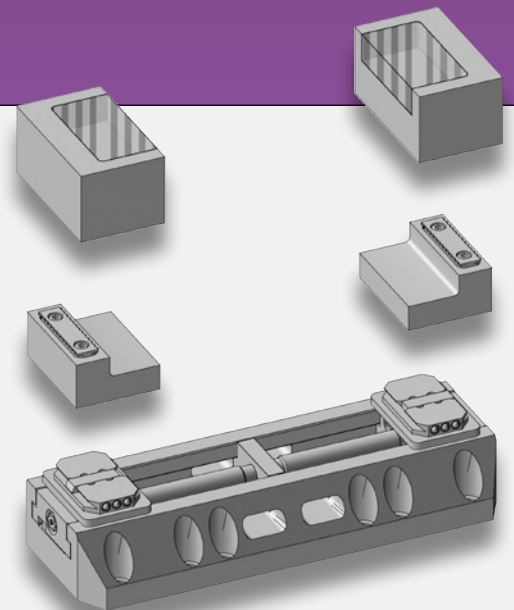

**ZSQP - mit Pendelfunktion**  
*ZSQP - with pendulum function*





**Module zum Spannen runder Werkstücke**  
*Modules for clamping round workpieces*

Art. Nr.		Ø	X	kg
<b>PAND30-34RV12-35</b>		12 – 35	30	~1,1
<b>PAND61-34RV35-80</b>		35 – 80	61	~1,26

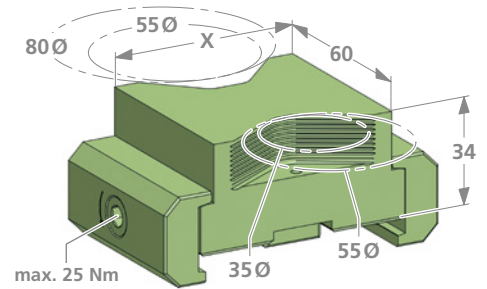
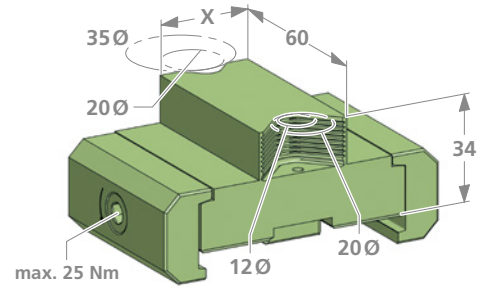

Runde Werkstücke, die einen Durchmesserbereich von 12 – 80 mm abdecken, können auf vielfältige Art gespannt werden.

Round workpieces covering a diameter range from 12 - 80 mm can be clamped in a variety of ways.

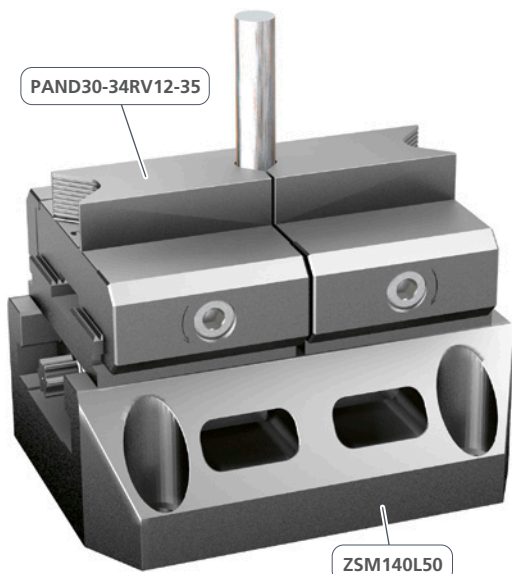
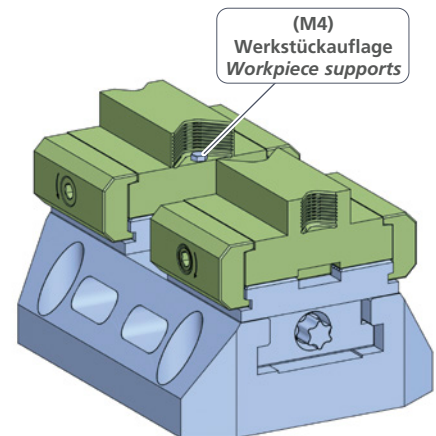
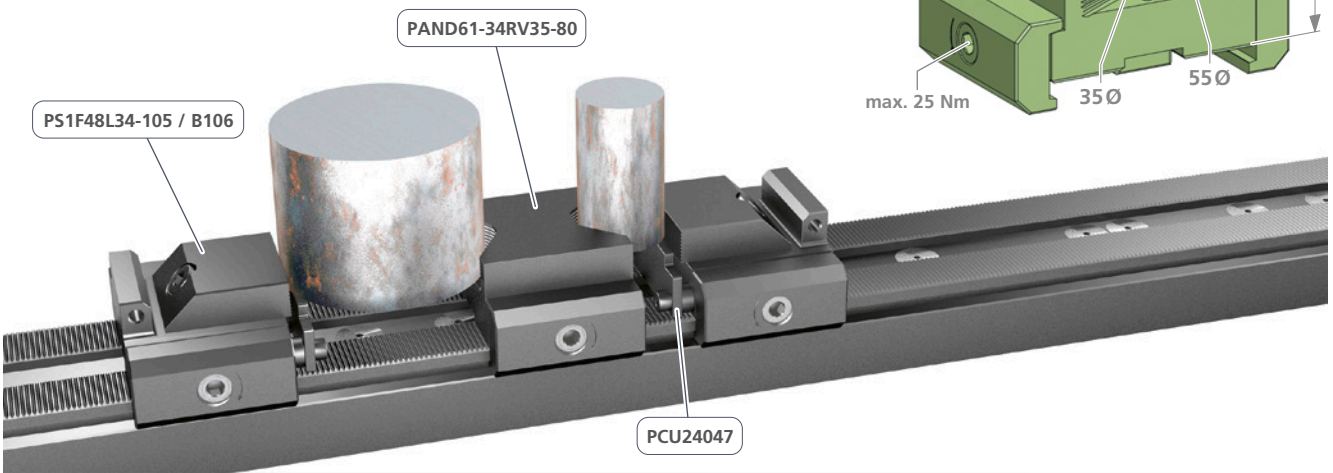

Drehmoment Torque		Spannkraft Workholding force		
Nm	(lb-ft)	~daN	~(lb)	~t
10	7,4	= 200	440	0,2
20	14,8	= 500	1'102	0,5
30	22,2	= 1'000	2'204	1,0
40	29,6	= 1'300	2'866	1,3
50	37,0	= 1'600	3'527	1,6

**NUSS3/8"TX30E14**

**WICHTIG!**  
 Bitte separat bestellen  
**IMPORTANT!**  
 Please order separately





**4-Achs Lösung für mechanische 0-Punkt Schnellwechselsystem**  
*4-axis solution for mechanical 0-point quick change systems*

Art. Nr.	Y	kg
<b>WU-18</b>	180	~14,1
<b>WU-25</b>	244	~16

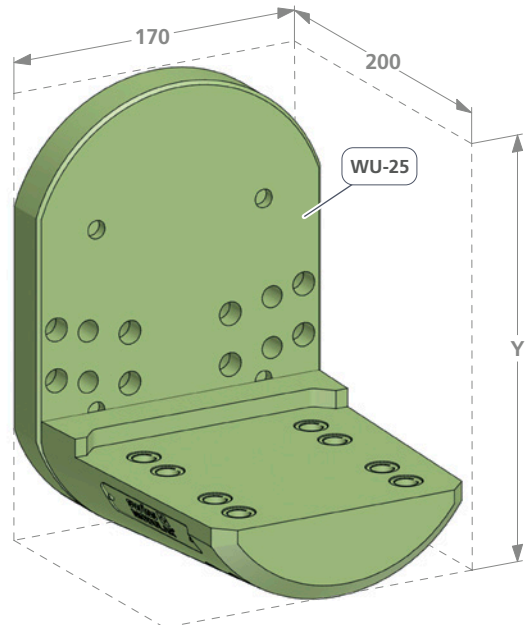
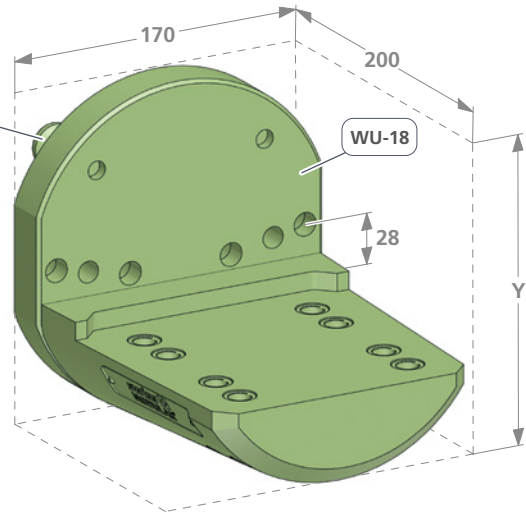
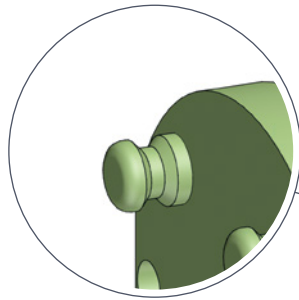

Flansch / Flange  
 Optional erhältlich  
 Optional accessory

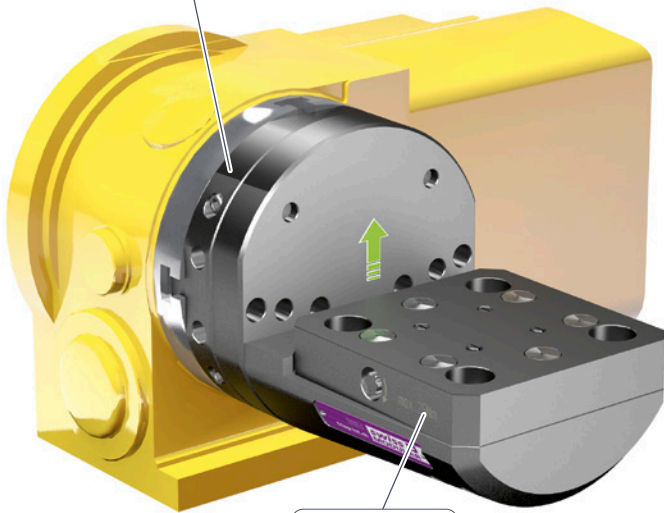

OPBM4Q100R50



ZSX140L50UPRG

Bei diesen Winkeln kann die Brücke für die Aufnahme der Spannmittel inklusive Werkstücke in der Höhe angepasst werden.

With these angles, the bridge can be adjusted in height to accommodate the clamping devices including workpieces.



Lösungen für mechanische 0-Punkt Schnellwechselsystem  
Solutions for mechanical 0-point quick change systems

**swiss**   
**MODULAR**<sup>®</sup>

## Schnell gewechselt

Da die Anforderungen an die „just in time“ Produktionen in den letzten Jahren stetig gewachsen sind, ist ein modulares Nullpunkt Schnellwechselsystem der richtige Weg um lange Standzeiten der Werkzeugmaschine zu verhindern.

- ✓ Sehr tiefe Bauhöhe (28 mm)
- ✓ Wiederholgenauigkeit 0,01 mm
- ✓ 6000 dAN Haltekraft
- ✓ Abhebefunktion ein- und ausschaltbar (3-4 mm)

VERSCHIEDENE / VARIOUS

# SPANNMITTEL WORKHOLDING

## powerCLAMP

## PALETTEN PALLETS ZUBEHÖR / ACCESSORIES



## MECHANISCHES / MECHANICAL 0-PUNKT 0-POINT SYSTEM

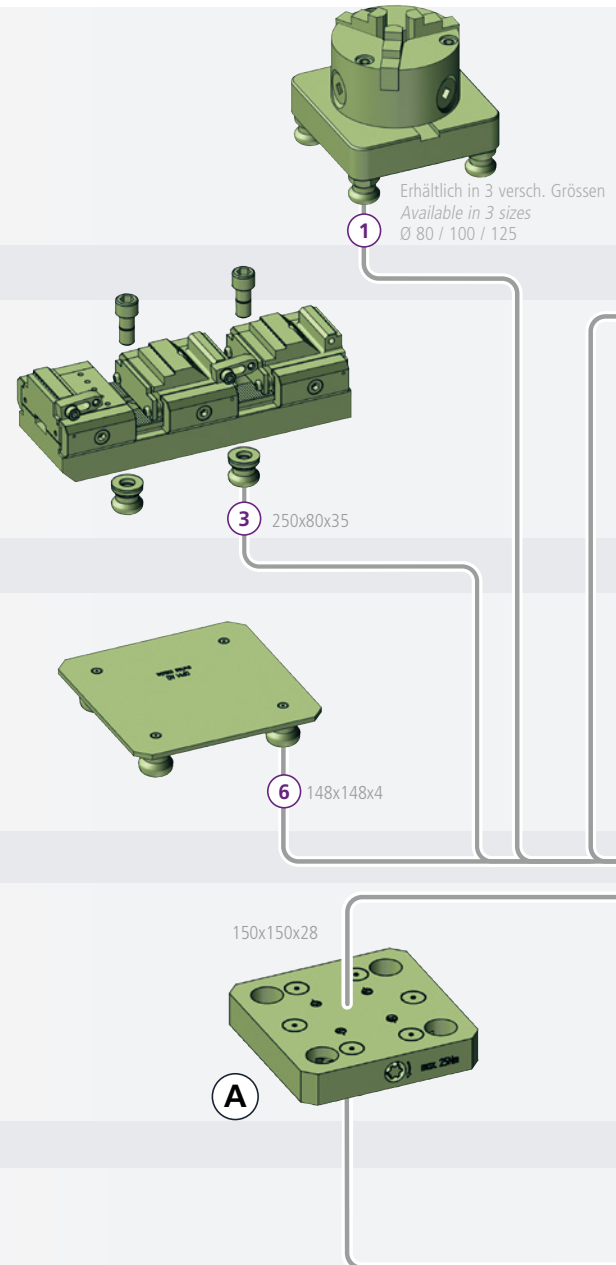



## WINKEL ANGLE FÜR 4. ACHSE / FOR 4TH AXIS



0-Punkt Basis / 0-point Base		kg
 (A)	<b>OPBM4Q100R50</b>	~3,8

3-Backenfutter 3-jaw chuck		Spannbereich Clamping area	kg
	<b>OPM3X80L75</b>	3-76	~5,8
 (1)	<b>OPM3X100L82</b>	3-100	~7,3
	<b>OPM3X125L88</b>	3-125	~9,5

Zentrischspanner Self centering vise		Spannbereich Clamping area	kg
	<b>ZSX140L50UPRG-OPM</b>	62-118	~7,1
	<b>ZSX160L50UPRG-OPM</b>	62-138	~7,7
 (2)	<b>ZSX180L50UPRG-OPM</b>	62-158	~8,1
	<b>ZSX200L50UPRG-OPM</b>	62-178	~8,8



## Changed quickly

Since the requirements for „just in time“ productions have grown steadily in the recent years, a modular zero-point quick-change system is the right way to prevent long machine down times.

- ✓ Very low height (28 mm)
- ✓ Repeat accuracy of 0,01 mm
- ✓ 6000 daN holding force
- ✓ Lift-off function can be switched on and off (3-4 mm)

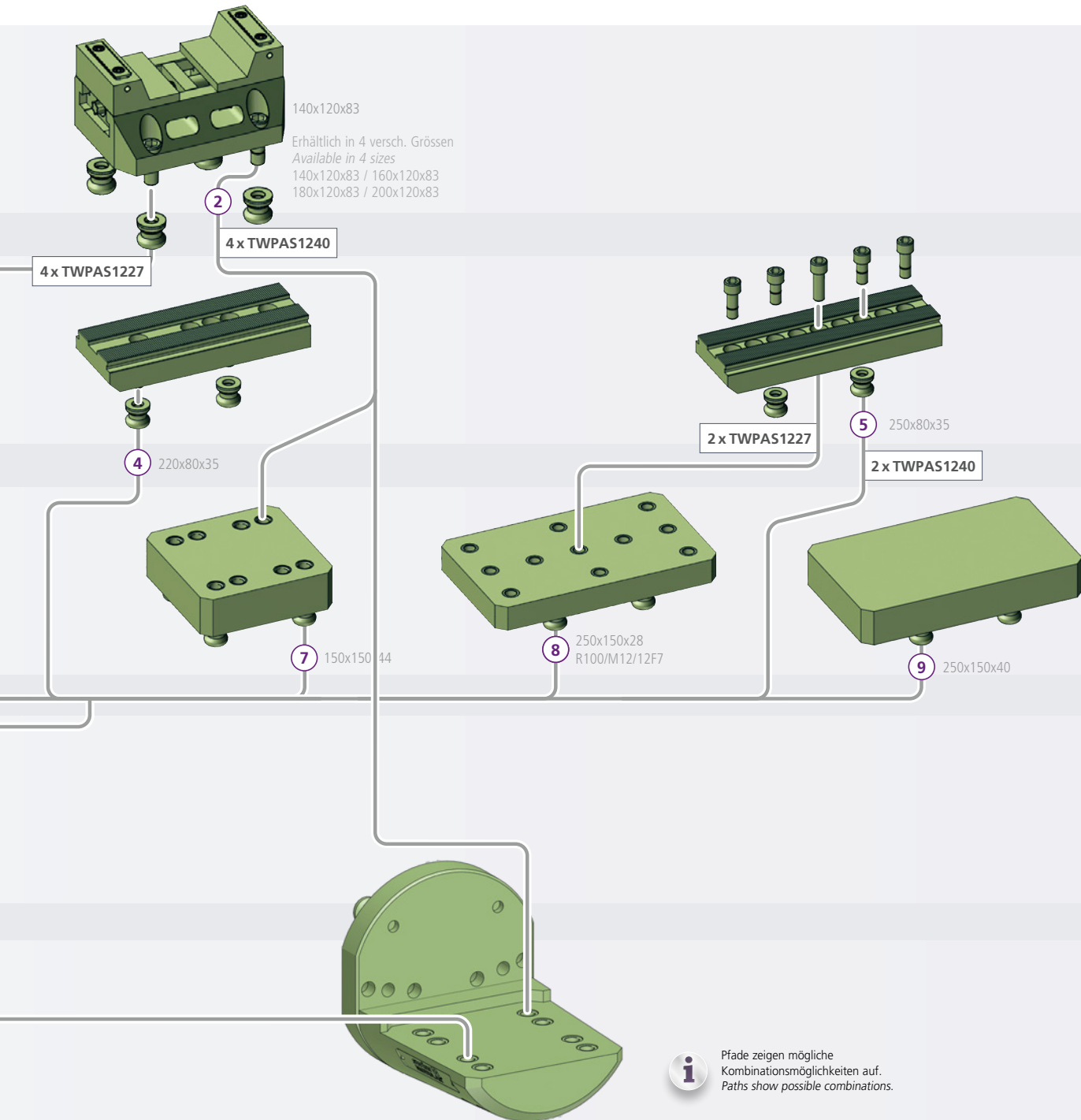

Pfade zeigen mögliche Kombinationsmöglichkeiten auf.  
Paths show possible combinations.

PowerCLAMP Set		kg
 ③	<b>PCSET18250-OPM</b>	~8,55
1x	PCSET18-250A / 03	~5,9
1x	PCSET18-L1 / B48-20	~2,65

Basisschiene diagonal Baserrail diagonal		kg
 ④	<b>PCSET18220W2-OPM</b>	~8,2

PC Schiene / PC Rail 250 mm		kg
 ⑤	<b>PCB2550250-OPM</b>	~4,8

Abdeckung / Cover		kg
 ⑥	<b>OPMAD</b>	~0,8

Erhöhung / Raiser block		kg
 ⑦	<b>OPUB150H44</b>	~8,5

Rasterplatte / Grid plate		kg
 ⑧	<b>OPM25-15R50H28</b>	~7,7

Aluminiumplatte / Aluminium plate		kg
 ⑨	<b>OPM25-15RH40</b>	~4,3

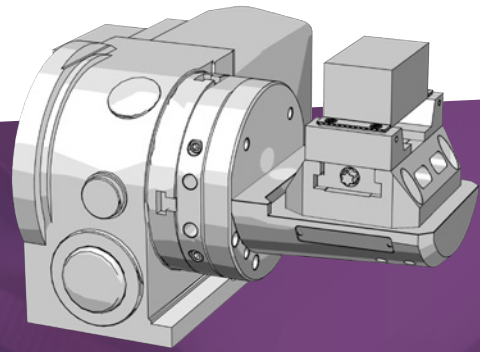
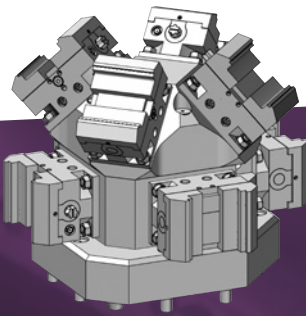
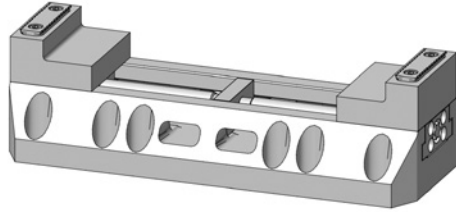

**Triag International AG**

Bösch 84 CH-6331 Hünenberg

☎ +41 41 727 27 77

✉ [spannen@triag-int.ch](mailto:spannen@triag-int.ch)

✉ [clamping@triag-int.ch](mailto:clamping@triag-int.ch)

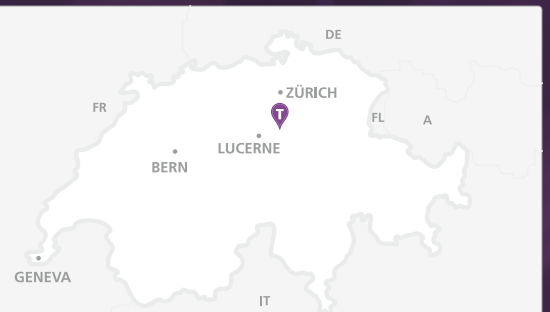

Mass- und Konstruktionsänderungen  
bleiben uns vorbehalten. *We reserve  
the right to modify dimensions and  
structural design.*

**swissmodular.com**

Official Website



**09**  
**23**